

**PLEASE CHECK WWW.MOLEX.COM FOR LATEST PART INFORMATION**

**Part Number:** [11-24-1009](#)  
**Status:** **Active**  
**Description:** Insulation Anvil

**Documents:**

[RoHS Certificate of Compliance \(PDF\)](#)

**General**

Product Family	Application Tooling
Series	<a href="#">T1001</a>
Comments	See Tooling Specification (PDF) Above
Function	Cutter
Geographic Area	Global
Level of Automation	Manual
More Detailed Tech Information	<a href="mailto:applicationtooling@molex.com">applicationtooling@molex.com</a>
Product Name	N/A
Survey	<a href="http://www.molex.com//review/apptool_survey.html">www.molex.com//review/apptool_survey.html</a>
Tool Type	Anvil
UPC	800754208628

**Material Info**

Old Part Number 4995 13

**Reference - Drawing Numbers**

Application Tooling Documents [ATS-STANDARD-PARTS](#)

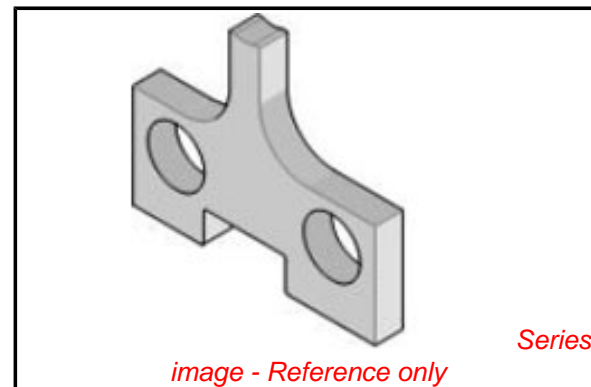

**EU RoHS**

**China RoHS**

**Compliance Status**

**Not Reviewed**

**REACH SVHC**

**Not Reviewed**

**Low-Halogen Status**

**Not Reviewed**

**Need more information on product environmental compliance?**

Email [productcompliance@molex.com](mailto:productcompliance@molex.com)  
 For a multiple part number RoHS Certificate of Compliance, [click here](#)

Please visit the [Contact Us](#) section for any non-product compliance questions.

**Search Parts in this Series**

[T1001Series](#)

**Use With**

[11-40-2096](#) , [11-40-2181](#) , [11-40-2206](#) ,  
[11-40-3007](#) , [11-40-3024](#) , [11-40-3096](#) ,  
[11-40-3099](#)

**PLEASE CHECK WWW.MOLEX.COM FOR LATEST PART INFORMATION**