

FC-220 Fiber Cleaver - Data Sheet

The FC-220 is a single fiber cleaver designed to accommodate either 900µm buffered or 250µm coated fiber. The FC-220 cleaver's quick and easy three-step operation is well suited for mechanical splice and quick termination field connector applications. The leaf spring base is ruled to allow for cleave lengths of 2 to 20mm. The standard carbide blade will perform up to 6000 cleaves.

Replacement Parts Available:

FC-4 - Replacement Blade

FC-65 - Replacement Leaf Spring

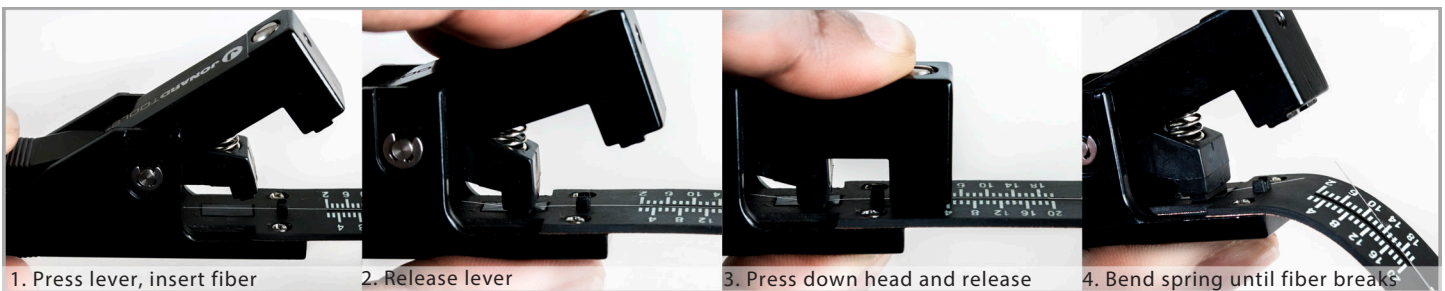

Specifications

For Use With	Single .125mm O.D. Fiber
Cleave Length	2.0mm to 20.0mm
Dimensions	124mm (L) x 20mm (W) x 40mm (H)
Operating Temperature	0 to 40 deg. C
Storage Temperature	-20 to 60 deg. C
Weight	0.132 lbs
FC-220 UPC No.	811490017078
FC-65 UPC No.	811490017320
FC-4 UPC No.	811490017313