

## SUMMARY

### # Wires

Low	10
High	0
Coax	0
Triax	0
Quad	0
Fiber	0
Fluidic	0

Series	2M
Termination type	Male crimp
IP rating	68
Cable Ø	6.50 - 13.00 mm
Matching parts	ECN.2M.310.XRM8
Status	
Alternative part	



Image is for illustrative purpose only

### Download

[Request a quote](#)

[Catalog](#)

## TECHNICAL DETAILS

### Mechanics

Shell Style/Model	FG*: Straight plug with arctic grip
Keying	3 keys (beta=165, gamma=30, plug: male contacts, receptacle: female contacts)
Housing Material	Environment friendly aluminium (nickel plated, anthracite color) shell and nut, other pieces bronze/brass
Cable Fixing	∅ 6.5 - 13 mm
Variant	

### Performance

Configuration	2M.310 : 10 Low Voltage
Insulator	
Rated Current	8 Amps

### Specifications

Contact Type: Crimp
Max. Matings: 5000
Contact Retention: 30 N
Contact Dia.: 0.9 mm (0.035in)
Bucket Dia.: 1.1 mm (0.043in)

Min. Conductor: 0.25 mm<sup>2</sup> (AWG 24)  
 Max. Conductor: 0.5 mm<sup>2</sup> (AWG 20)  
 R (max): 4.8 mOhm  
 Test voltage (kV rms) Contact-contact: 1.8  
 Test voltage (kV rms) Contact-shell: 1.2

## Others

Humidity (max): <=95% [at 60 deg C / 140 F]  
 Vibration: 15 g [10 Hz - 2000 Hz]  
 Shock Resistance: 100 g [ 6 ms]  
 Operating temperature: -55 °C / +200 °C  
 Climatical Category: 15/200/21 (Al. shell)  
 Lighting strike EIA 364-75 10K amps - 6 times  
 EMI Shielding EIA 364-66A - 1Ghz-80 dB, 3GHz-70 dB, 6GHz- 58dB  
 IP Rating: 68

## DRAWINGS

### Draws

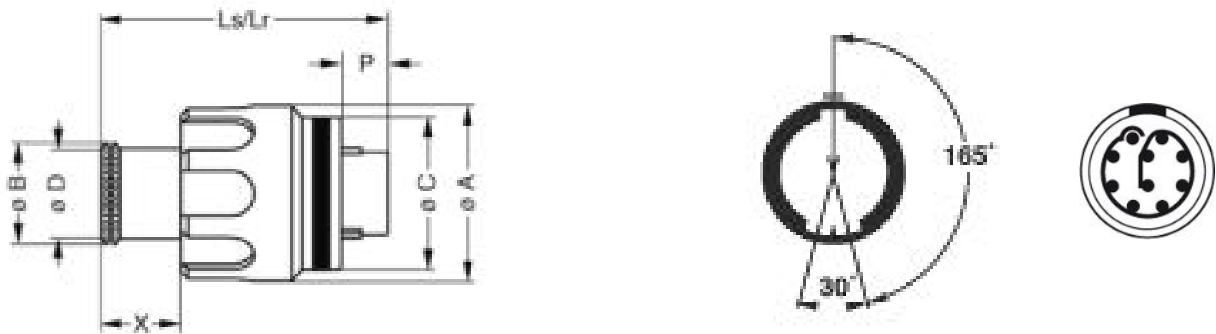

### Dimensions

	A	B	C	D	Lr	Ls	P	X
mm.	18.9	14	17.2	13	24.5	24.5	3.9	7.1
in.	0,74	0,55	0,68	0,51	0,96	0,96	0,15	0,28

## RECOMMENDED BY LEMO

### Tools

Crimp Tool: DPC.91.701.V  
 Crimp settings: AWG/Selector = 22-24-26 16-18-20/6-5-5 8-7-7

Positionner: DCE.91.070.5MVC  
 Positionner 2: DCE.91.130.5MVC  
 Extractor: DCF.93.131.4LT  
 Extractor 2: DCF.93.070.4LT  
 Replacement contact: FGN.0M.555.ZZC / FGN.0M.565.ZZC

## Cables

CMN.10.T20.080PGCE	PVC	GREY	
CMN.10.T20.080PGZE		Grey	
CMN.10.T20.080PNCE	PVC	Black	
CMN.10.T20.080PNZE			
CMN.10.T20.080QGC	TPR	Grey	
CMN.10.T22.068PGCE	PVC	GREY	
CMN.10.T22.068PGZE		Grey	
CMN.10.T22.068PNCE	PVC	Black	
CMN.10.T22.068PNZE			
CMN.10.T22.068QGZE	TPR (medical)	Grey	
110 220	PVC	Black	
210 200	PVC	Black	
210 240	PVC	Black	
210 250	PVC	Grey	