

**LEGEND:**

5569 - N A \* \* \* \* \*

BASE NUMBER

CIRCUIT SIZE

ASSEMBLY

MOUNTING OPTION (SEE NOTE 6.)

PLATING (SEE NOTE 2.)

HOUSING MAT'L. (SEE NOTE 1.)

PACKAGING (SEE NOTE 4.)

CIRCUIT SIZE	DIM. "A"	DIM. "B"
6	.54 (13.8)	.33 (8.4)
8	.71 (18.0)	.50 (12.6)
10	.87 (22.2)	.66 (16.8)
12	1.04 (26.4)	.83 (21.0)
14	1.20 (30.6)	.99 (25.2)
16	1.37 (34.8)	1.16 (29.4)
18	1.54 (39.0)	1.32 (33.6)
20	1.70 (43.2)	1.49 (37.8)
22	1.87 (47.4)	1.65 (42.0)
24	2.03 (51.6)	1.82 (46.2)

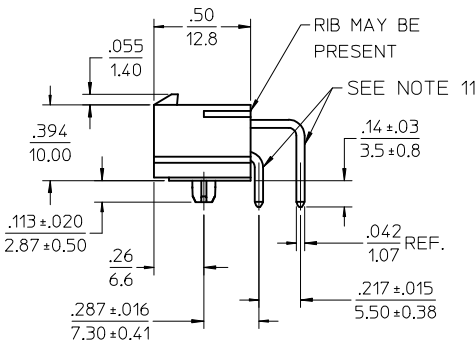

THIS VIEW APPLIES TO ALL CIRCUIT SIZES

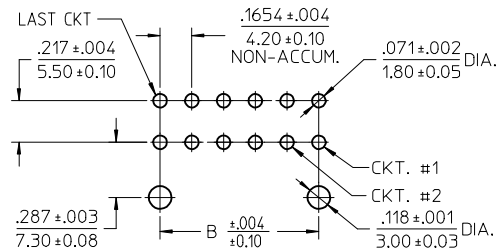
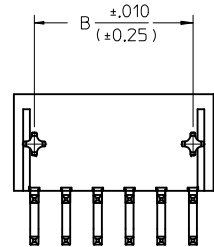
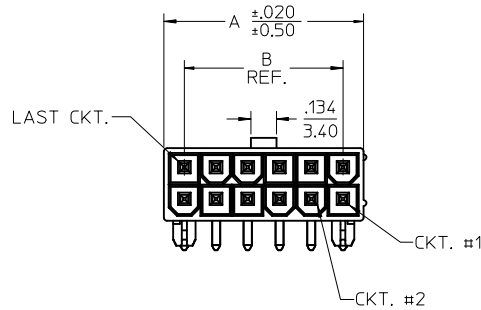

RECOMMENDED HOLE LAYOUT FOR .070/(1.78) MAX. THICK P.C. BOARD VIEWED FROM COMPONENT SIDE FOR 6 THRU 24 CIRCUITS

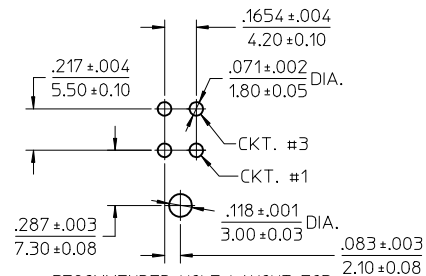
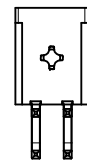
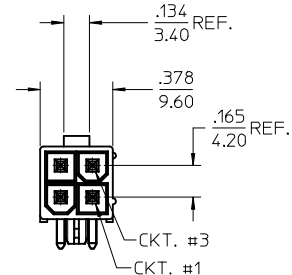

RECOMMENDED HOLE LAYOUT FOR .070/(1.78) MAX. THICK P.C. BOARD VIEWED FROM COMPONENT SIDE FOR 4CKT PARTS

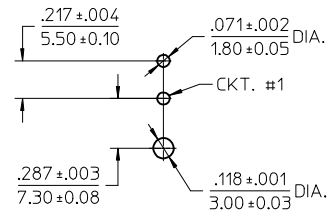
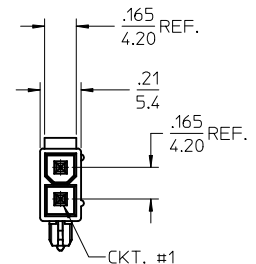

RECOMMENDED HOLE LAYOUT FOR .070/(1.78) MAX. THICK P.C. BOARD VIEWED FROM COMPONENT SIDE FOR 2CKT PARTS

- NOTES:
- MATERIAL: HOUSING: \*130\* = GLASS FILLED LCP, UL94V-0, COLOR - BLACK; TERMINAL: BRASS ALLOY
  - FINISH (PLATING): \*MS\* = .000100/(0.00254) MIN. MATTE TIN OVER .000050/(0.00127) MIN. NICKEL
  - PRODUCT SPECIFICATION: SEE CHARTS
  - PACKAGING: \*T\* = TRAY PACKED PER PK-5569-003
  - PART MATES WITH MINI-FIT JR. RECEPTACLE SERIES 5557.
  - MOUNTING OPTIONS: 7 = PRESS FIT PEG
  - DISCOLORATION IN THE BANDOLIER CARRIER AREA OF THE PIN IS INHERENT TO THE PLATING PROCESS AND IS DUE TO THE MASKING EFFECT OF THE CARRIER. THIS DISCOLORATION IS IN A NON-FUNCTIONAL AREA OF THE PIN AND WILL NOT AFFECT THE PERFORMANCE OF THE HEADER ASSEMBLY.
  - PART CONFORMS TO CLASS "B" REQUIREMENTS OF COSMETIC SPECIFICATION PS-45499-002.
  - CONNECTORS ARE NOT TO BE MATED AND UNMATED WHILE CIRCUITS ARE LIVE.
  - PARTS ARE NOT DESIGNED FOR CURRENT SHARING.
  - FORMING MARKS ON PINS ARE ACCEPTABLE.

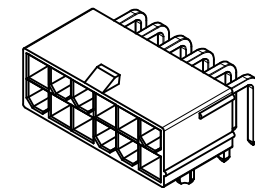

REV	DESCRIPTION	QUALITY SYMBOLS
A3	CHG 2 CKT TO TOOLED EC NO: UCP2013-3729 IDRWANGUYEN 2013/04/01 CHKD: BELL 2013/04/01 APPR: FSMITH 2013/04/25	▽=0 ▽=0 ▽=0

GENERAL TOLERANCES (UNLESS SPECIFIED)	
mm	INCH
4 PLACES ±---	±---
3 PLACES ±---	±.015
2 PLACES ±.38	±.015
1 PLACE ±.38	±---
0 PLACE ±---	±---
ANGULAR ±1/2°	
DRAFT WHERE APPLICABLE MUST REMAIN WITHIN DIMENSIONS	

DIMENSION STYLE	
IN/MM	
DRAWN BY	DATE
JJAGUIALR	2009/07/27
CHECKED BY	DATE
JBELL	2009/07/27
APPROVED BY	DATE
FSMITH	2009/07/31
MATERIAL NO.	
SEE CHART	

SCALE	DESIGN UNITS	THIRD ANGLE PROJECTION
2:1	METRIC	THIRD ANGLE PROJECTION
TITLE		
MINI-FIT JR RIGHT ANGLE HEADER ASSEMBLIES WITH MTG. PEGS (LCP)		
<b>molex</b>		
DOCUMENT NO.	SHEET NO.	
SD-5569-NA2*-130	1 OF 2	
THIS DRAWING CONTAINS INFORMATION THAT IS PROPRIETARY TO MOLEX. INCORPORATED AND SHOULD NOT BE USED WITHOUT WRITTEN PERMISSION		

TOOLED	PART NO.	ENG. NO.	CKT. SIZE	MOUNTING OPTION	PLATING (SEE NOTE 2)	HOUSING MATERIAL (SEE NOTE 1)	PACKAGING	PRODUCT SPECIFICATION
YES	50-36-2457	5569-02A7MS-130-T	2	PRESS FIT PEGS	MATTE TIN/NICKEL	94V-0	TRAY PACKAGED PER PK-5569-003	PS-5556-004
NO	50-36-2459	5569-04A7MS-130-T	4	PRESS FIT PEGS	MATTE TIN/NICKEL	94V-0		
YES	50-36-2462	5569-06A7MS-130-T	6	PRESS FIT PEGS	MATTE TIN/NICKEL	94V-0		
NO	50-36-2464	5569-08A7MS-130-T	8	PRESS FIT PEGS	MATTE TIN/NICKEL	94V-0		
	50-36-2466	5569-10A7MS-130-T	10	PRESS FIT PEGS	MATTE TIN/NICKEL	94V-0		
YES	50-36-2296	5569-12A7MS-130-T	12	PRESS FIT PEGS	MATTE TIN/NICKEL	94V-0		
	50-36-2428	5569-14A7MS-130-T	14	PRESS FIT PEGS	MATTE TIN/NICKEL	94V-0		
	50-36-2426	5569-16A7MS-130-T	16	PRESS FIT PEGS	MATTE TIN/NICKEL	94V-0		
NO	50-36-2468	5569-18A7MS-130-T	18	PRESS FIT PEGS	MATTE TIN/NICKEL	94V-0		
	50-36-2471	5569-20A7MS-130-T	20	PRESS FIT PEGS	MATTE TIN/NICKEL	94V-0		
	50-36-2473	5569-22A7MS-130-T	22	PRESS FIT PEGS	MATTE TIN/NICKEL	94V-0		
	50-36-2475	5569-24A7MS-130-T	24	PRESS FIT PEGS	MATTE TIN/NICKEL	94V-0		

<b>SEE SHEET 1</b> EC NO: UCP2013-3729 DRW: NGUYEN 2013/04/01 CHKD: JBELL 2013/04/01 APPR: FSMITH 2013/04/25	QUALITY SYMBOLS 	GENERAL TOLERANCES (UNLESS SPECIFIED)		DIMENSION STYLE <b>IN/MM</b>	SCALE <b>1:1</b>	DESIGN UNITS <b>METRIC</b>	THIRD ANGLE PROJECTION	
				DRAWN BY JJAGUIALR	DATE 2009/07/27	TITLE <b>MINI-FIT JR RIGHT ANGLE          HEADER ASSEMBLIES WITH          MTG. PEGS (LCP)</b>		
				CHECKED BY JBELL	DATE 2009/07/27			
				APPROVED BY FSMITH		DATE 2009/07/31	<b>molex</b> DOCUMENT NO. <b>SD-5569-NA2*-130</b>	
		MATERIAL NO. <b>SEE CHART</b>		SHEET NO. 2 OF 2				
DRAFT WHERE APPLICABLE MUST REMAIN WITHIN DIMENSIONS		ANGULAR $\pm 1/2^\circ$		THIS DRAWING CONTAINS INFORMATION THAT IS PROPRIETARY TO MOLEX INCORPORATED AND SHOULD NOT BE USED WITHOUT WRITTEN PERMISSION				