

LOC AP DIST -

REVISIONS					
P	LTR	DESCRIPTION	DATE	DWN	APVD
A		RELEASED	31JAN2012	CRM	CCL
B		ECO-14-005790	22APR2014	EAO	CCL

DADOS DE GRAMPEAÇÃO (CRIMPING DATA)			
DESCRIÇÃO DO TERMINAL (TERMINAL DESCRIPTION)			
TAB 9,5x0,8 MM			
LET. DO DISCO (DISC LETTER)	ALTURA DE FECHAMENTO (CRIMP HEIGHT)	BITOLA (WIRE SIZE)	
C3	4,05 MM	16,00 MM ²	
C8	3,90 MM	6 AWG	
-	-	-	
COMPRIMENTO DO DECAPE (WIRE STRIP LENGTH) 12,00 MM		ESPECIFICAÇÃO DE APLICAÇÃO (TERMINAL APPL. SPEC)	
GRAMPEADOR (CRIMPER)	LARGURA (CRIMP WIDTH)	TIPO (TYPE)	PASSO (APPLICATOR FEED)
CONDUTOR (WIRE)	6,60 (.260)	F	32,50 MM
ISOLANTE (INSULATION)	9,14 (.360)	F	
DIAM. DO ISOLANTE (INSULATION RANGE) 7,0 - 8,1 MM	PARA BITOLAS (WIRE RANGE) >10,0 - 16,0 MM ²	GABARITO DE MONT. (GAUGE)	
PARA APLICAR TERMINAL: (TERMINALS APPLIED)			
TERMINAL	SELO (SEAL)	TERMINAL	SELO (SEAL)
2177213	-	-	-

NOTAS:
 1-USAR PROTEÇÃO QUANDO FOR USADO EM PRENSA DE BANCADA.
 2-APENAS OS ITENS COM QUANTIDADES ESPECIFICADAS SÃO USADOS NESTE APLICADOR.

RECOMENDAÇÕES:
 □ PEÇAS DE DESGASTE O CLIENTE SERÁ RESPONSÁVEL PELA REPOSIÇÃO.
 ▢ -ENGRAXAR LEVEMENTE.

NOTES:
 1-GUARD MUST BE IN PLACE WHEN OPERATING APPLICATOR IN BENCH PRESS.
 2-ONLY THE ITEMS WITH QUANTITY ARE USED ON THIS APPLICATOR.

KEYS:
 □ SPARE PARTS RECOMMENDED.
 ▢ -GREASY LIGHTLY.

THIS APPLICATOR MUST BE USED ON PRESSES WITH CONVENTIONAL APPLICATOR BASE PLATE RECOMMENDED: CRIMPATIC PRESS-970

QTD POR MONTAGEM (QTY PER ASS'Y)	NUMERO (PART NUMBER)	DESCRIÇÃO (DESCRIPTION)	ITEM
-	1	4-2076140-0 TUBO DE POLIURETANO (1100 MM)	TUBE 99
-	1	2076057-1 ESPAÇADOR DA GUIA TRASEIRA	SPACER, REAR STRIP GUIDE 97
-	1	1-992946-4 PINO DE AJUSTE (3,0DIA.X8)	PIN DOWEL 96
-	1	1-18023-3 PARAF. ALL CAB. CILINDRICA (M4X16)	SCREW, CAP, SKT HEAD 95
-	2	1-18023-1 PARAF. ALL CAB. CILINDRICA (M4X10)	SCREW, CAP, SKT HEAD 94
-	1	2076582-1 PROTEÇÃO	APPLICATOR GUARD 93
-	1	1707368-1 ESPAÇADOR DA PROTEÇÃO	SPACER, APPLICATOR GUARD 92
-	4	18024-9 PARAF. ALL CAB. BOL. (M4X16)	SCREW, BUTTON, SKT HEAD 91
-	2	1-18024-2 PARAF. ALL CAB. BOL. (M5X12)	SCREW, BUTTON, SKT HEAD 90
-	1	1-18024-2 PARAF. ALL CAB. BOL. (M5X12)	SCREW, BUTTON, SKT HEAD 89
-	1	1707660-2 BASE	BASE PLATE 88
-	1	1707668-1 CAPA DA FACA	SHEAR HOLDER, FRONT 87
-	1	624428-2 LIMITADOR DA FACA	STOP SHEAR 86
-	2	3-22280-5 MOLA DA FACA FLUTUANTE	SPRING, COMPRESSION 85
-	1	1707747-1 FACA FLUTUANTE	FLOATING SHEAR FRONT 84
1	1	2076069-3 BIGORNA	ANVIL 83
-	1	1707679-7 SUPORTE DO TERMINAL	TERMINAL SUPPORT 82
-	2	1-18024-2 PARAF. ALL CAB. BOL. (M5X12)	SCREW, BUTTON, SKT HEAD 81
-	2	1-18024-2 PARAF. ALL CAB. BOL. (M5X12)	SCREW, BUTTON, SKT HEAD 80
-	5	1-18024-9 PARAF. ALL CAB. BOL. (M6X16)	SCREW, BUTTON, SKT HEAD 79
-	2	992946-3 PINO DE AJUSTE (6,0DIA.X20)	PIN DOWEL 78
-	1	197352-4 AJUSTADOR DA GUIA	ADJUSTMENT SCREW 77
-	2	2-18023-0 PARAF. ALL CAB. CILINDRICA (M5X16)	SCREW, CAP, SKT HEAD 76
-	1	1707671-1 BLOCO DA PLACA GUIA	BASE BLOCK ADJUSTMENT 75
-	1	1707670-1 PINO DO BLOCO DA PLACA GUIA	PIN DOWEL 74
-	1	1707675-1 BLOCO ESPAÇADOR	SCREW BLOCK 73
-	1	1707121-2 PARAFUSO DO LIBERADOR	SPECIAL SCREW 72
-	1	1707543-1 LIBERADOR DO FREIO	LEVER, DRAG RELEASE 71
-	2	2-18023-2 PARAF. ALL CAB. CILINDRICA (M5X25)	SCREW, CAP, SKT HEAD 70
-	1	624817-1 FREIO	DRAG, TERMINAL 69
-	2	1-22284-1 MOLA DO FREIO	SPRING, COMPRESSION 68
7--1	-1	NUMERO (PART NUMBER)	DESCRIÇÃO (DESCRIPTION)
7--1	-1	NUMERO (PART NUMBER)	DESCRIÇÃO (DESCRIPTION)

QTD POR MONTAGEM (QTY PER ASS'Y)	NUMERO (PART NUMBER)	DESCRIÇÃO (DESCRIPTION)	ITEM
-	1	1707672-9 PLACA GUIA DA FITA	STRIP GUIDE PLATE 67
-	1	1707674-5 GUIA DIANTEIRA	FRONT STRIP GUIDE 66
-	2	18023-5 PARAF. ALL CAB. CILINDRICA (M3X12)	SCREW, CAP, SKT HEAD 65
-	1	2076058-9 GUIA TRASEIRA	REAR STRIP GUIDE 64
-	2	1-18023-5 PARAF. ALL CAB. CILINDRICA (M4X25)	SCREW, CAP, SKT HEAD 63
-	2	624445-2 ARRUELA ESPECIAL	SPECIAL WASHER 62
-	3	1-18023-2 PARAF. ALL CAB. CILINDRICA (M4X12)	SCREW, CAP, SKT HEAD 61
-	1	624365-3 PLACA DE REGULAGEM DO CILINDRO	PLATE, CYLINDER ADJUSTMENT 59
-	2	2-18023-1 PARAF. ALL CAB. CILINDRICA (M5X20)	SCREW, CAP, SKT HEAD 58
-	1	624368-2 PARAF. REGULAGEM DO CILINDRO	SCREW, CYLINDER ADJUSTMENT 57
-	1	5-519003-5 PARAF. REGUL. DO STOP DO CILINDRO	SCREW, SLOTTED PAN HEAD 56
-	1	3-197574-9 CONEXÃO RETA (OSM-M5-6) FESTO	COUPLING 55
-	2	18023-6 PARAF. ALL CAB. CILINDRICA (M3X16)	SCREW, CAP, SKT HEAD 54
-	1	624366-2 SUPORTE DO ENGATE	FAST COUPLER SUPPORT 53
-	1	9-197017-3 CONEXÃO RETA (OSM-M5-4-1) FESTO	COUPLING 52
-	1	1-624367-0 SUPORTE DO CONJ. DE ALIMENTAÇÃO	SUPPORT, SET FEEDING 51
-	2	2-18023-0 PARAF. ALL CAB. CILINDRICA (M5X16)	SCREW, CAP, SKT HEAD 50
-	1	690191-1 PLUG DE NYLON	PLUG, NYLON 49
-	1	18023-9 PARAF. ALL CAB. CILINDRICA (M4X6)	SCREW, CAP, SKT HEAD 48
-	1	3-21028-9 PINO ELÁSTICO (3,2 DIA.X25)	PIN, SLOTTED SPRING 47
-	1	624364-3 SUPORTE DO CILINDRO	CYLINDER SUPPORT 46
-	2	9-197017-1 REGULADORA DE FLUXO (GRLA-M5-0S-4B) FESTO	FLOW CONTROL 45
-	1	1707009-3 SUPORTE DO DEDO	HOLDER, FEED FINGER 44
-	1	9-197017-9 CILINDRO DUPLA AÇÃO (ADVUL-20-40-PA) FESTO	CYLINDER 43
-	1	1-18023-9 PARAF. ALL CAB. CILINDRICA (M5X12)	SCREW, CAP, SKT HEAD 42
-	-	ESPAÇADOR DO CONJUNTO DE ALIMENTAÇÃO	SPACER, SET FEEDING 41
-	1	2076019-2 ALOJAMENTO	HOUSING 40
-	4	2-18023-5 PARAF. ALL CAB. CILINDRICA (M5X50)	SCREW, CAP, SKT HEAD 39
-	1	240624-1 PINO DO DEDO	PIN, FEED FINGER 38
-	2	21045-3 ANEL ELÁSTICO "C" (4,75 DIA.)	RING, RETAINING 37
-	1	691499-1 MOLA DO DEDO	SPRING, FEED FINGER 36
-	1	690541-1 SUPORTE DO DEDO DE AVANÇO	HOLDER, FEED FINGER 35
-	1	1-18023-0 PARAF. ALL CAB. CILINDRICA (M4X8)	SCREW, CAP, SKT HEAD 34
-	1	18025-2 ARRUELA DE PRESSÃO (M4)	WASHER, SPRING LOCK 33
-	1	1707678-1 DEDO DE AVANÇO	FEED FINGER 32
-	2	9-197017-2 CONEXÃO "L" (OSM-M5-4) FESTO	COUPLING 90° 31
-	1	624424-1 VÁLVULA 5/2 VIAS	PNEUMATIC VALVE (5/2 WAYS) 30
-	1	9-197017-3 CONEXÃO RETA (OSM-M5-4-1) FESTO	COUPLING 29
-	2	1-18023-4 PARAF. ALL CAB. CILINDRICA (M4X20)	SCREW, CAP, SKT HEAD 28
-	1	1707663-1 CAPA DO BATENTE	CAP, RAM 27
-	1	2076020-5 EXTRATOR	STRIPPER 26
-	1	1-18024-2 PARAF. ALL CAB. BOL. (M5X12)	SCREW, BUTTON, SKT HEAD 25
-	1	240659-3 PINO ACIONADOR DO CAME	PIN, ROLLER CAM 24
-	1	240658-1 ACIONADOR DO CAME	ROLLER CAM 23
-	1	624762-4 EIXO ACIONADOR DO CAME	ROD FEED 22
-	1	2-18023-1 PARAF. ALL CAB. CILINDRICA (M5X20)	SCREW, CAP, SKT HEAD 21
-	1	18025-3 ARRUELA DE PRESSÃO (M5)	WASHER, SPRING LOCK 20
-	1	21028-2 PINO ELÁSTICO (1,6 DIA.X6,5)	PIN SLOTTED SPRING 19
-	1	2-985575-0 PARAF. CAB. CHANFRADA (M5X12)	SCREW, CAP, FLAT HEAD 18
-	1	18030-3 PORCA SEXTAVADA (M5)	NUT, HEX 17
-	1	1707007-2 CAME	CAM 16
-	1	985575-3 PARAF. CAB. CHANFRADA (M3X10)	SCREW, CAP, FLAT HEAD 15
-	1	1707670-1 DISCO DE AJUSTE FINO	WIRE DISC, FINE ADJUSTMENT 14
-	1	1707150-1 ARRUELA LISA	WASHER FLAT 13
-	1	1707662-1 BATENTE	RAM 12
-	1	690191-1 PLUG DE NYLON	PLUG, NYLON 11
-	1	18032-8 PARAF. ALL S/ CAB. (M6X8)	SCREW, SET, SKT, FLAT POINT 10
-	1	1707676-8 BLOCO DO BATENTE	BLOCK, INSULATION ADJUSTMENT 09
-	1	1707121-2 PARAF. DO BLOCO DO BATENTE	SCREW, SOCKET, SHOULDER HEAD 08
1	1	2-1707664-0 GRAMPEADOR DO CONDUTOR	WIRE CRIMPER 07
-	1	1707680-8 ESPAÇADOR DE GRAMPEAÇÃO	CRIMPER SPACER 06
1	1	1707725-7 GRAMPEADOR DO ISOLANTE	INSULATION CRIMPER 05
-	1	2-238011-7 ESPAÇADOR TUBULAR	BLOCK, CRIMPER SPACER 04
-	1	1707680-1 ESPAÇADOR DE GRAMPEAÇÃO	CRIMPER SPACER 03
-	1	1-1707669-1 DEPRESSOR DA FACA	DEPRESSOR, SHEAR FRONT 02
-	1	2-18024-8 PARAF. ALL CAB. BOL. (M8X40)	SCREW, BUTTON, SKT HEAD 01

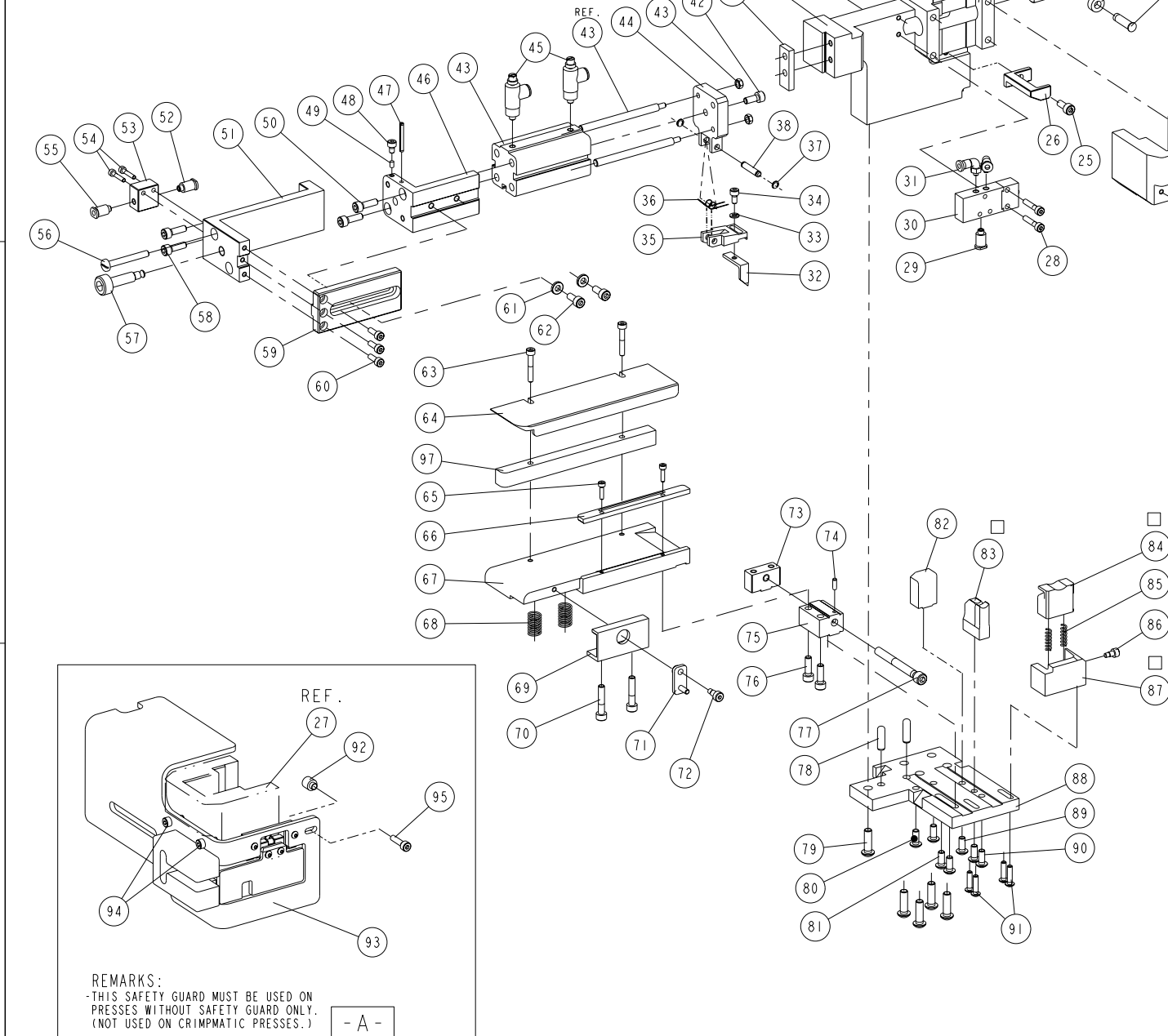

REMARKS:
 -THIS SAFETY GUARD MUST BE USED ON PRESSES WITHOUT SAFETY GUARD ONLY. (NOT USED ON CRIMPATIC PRESSES.)

THIS DRAWING IS A CONTROLLED DOCUMENT.

DIMENSIONS: mm	TOLERANCES UNLESS OTHERWISE SPECIFIED:
0 PLC ±	1 PLC ±
2 PLC ±	3 PLC ±
4 PLC ±	ANGLES ±
MATERIAL	FINISH

DWN C. MENEGHINI 31JAN2012	CHK P. BARLETTA 31JAN2012	APVD C. LIMA 31JAN2012
PRODUCT SPEC		
APPLICATION SPEC		
WEIGHT	SCALE	SHEET OF REV B
CUSTOMER DRAWING		

TE Connectivity
 MID SIZE WIRE APPLICATOR (SIDE FEED VERSION)
 SIZE CAGE CODE DRAWING NO A200779C-1893357