

PART NUMBER	REV	FIRST USED
567913-1	C	854040-3

PIN		SOCKET		VISIBLE PAD LTR		CRIMPING DATA	
.500 FEED		770007 770008		CRIMP HEIGHT		WIRE SIZE	
A	.069 ±.002 [1.75 ±0.05mm]			14			
B	.059 ±.002 [1.5 ±0.05mm]			16			
.620 FEED		770193		CRIMP		WIRE SIZE	
C	.052 ±.002 [1.32 ±0.05mm]			18			
D	.047 ±.002 [1.19 ±0.05mm]			20			
WIRE STRIP LENGTH		TERM APPL SPEC	FEED	APPL INSTRUCTION	SET UP GAGE	LAYOUT	
-		114-1043	.500/.620	SEE CUSTOMER MANUAL	NONE	L1675	

SIM TO HOM 567213

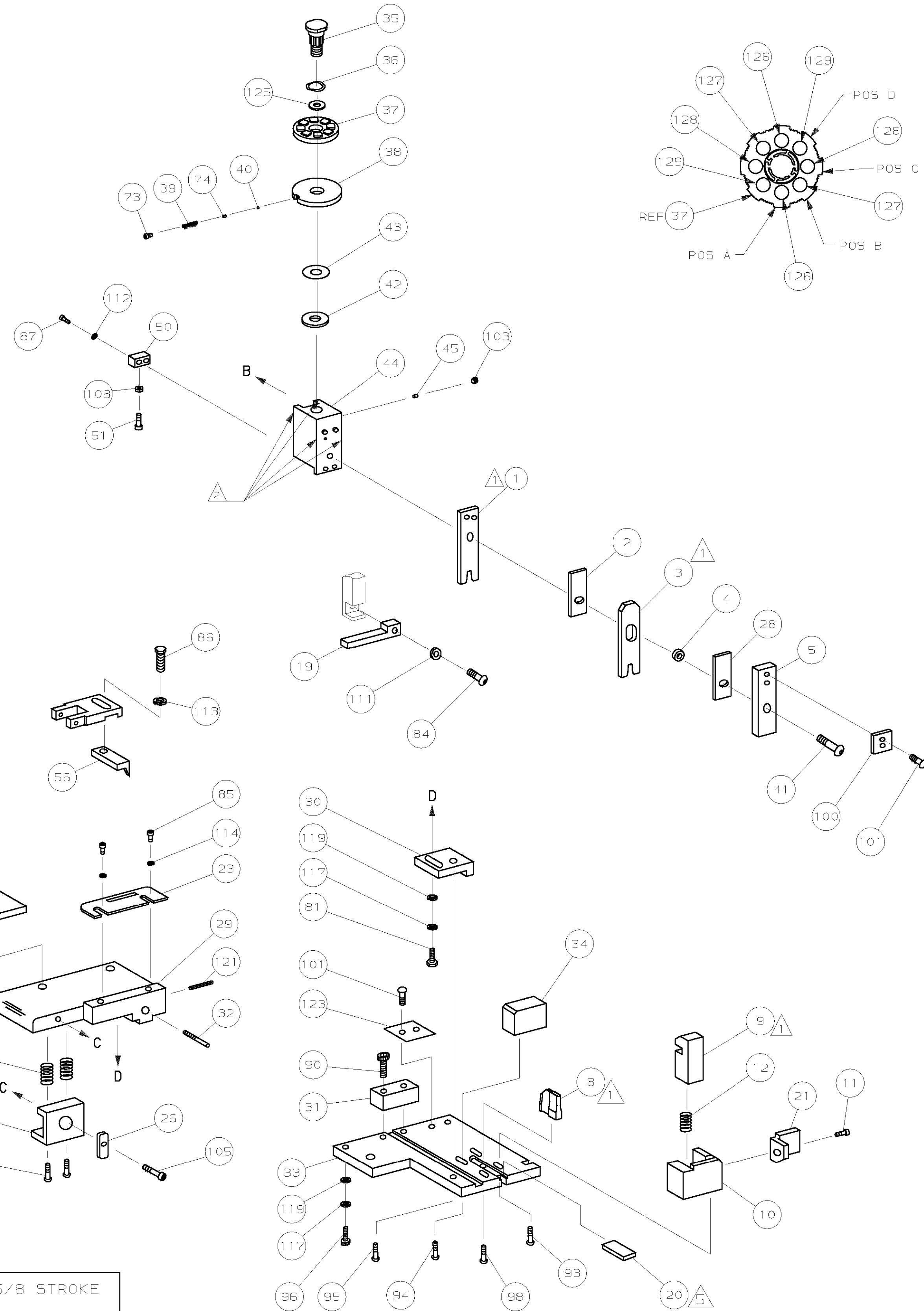

- ▲1 RECOMMENDED SPARE PARTS.
- ▲2 GREASE LIGHTLY.
- ▲3 ITEM NOT SHOWN
- ▲4 CUT TO LENGTH AT ASSY
- ▲5 USE LOCTITE SUPERBOND TO ADHERE ITEM 20 INSIDE SLOT IN BASE PLATE IN FRONT OF ANVIL.

QTY	REV	TER	APPL	SPEC	FEED	APPL INSTRUCTION	SET UP GAGE	LAYOUT
2	-	C	1-354779-8	PIN, WIRE DISC (.3080)D	129			
2	-	C	9-354778-7	PIN, WIRE DISC (.2980)C	128			
2	-	C	4-354779-4	PIN, WIRE DISC (.3210)B	127			
2	-	C	3-354779-4	PIN, WIRE DISC (.3160)A	126			
1	-	A	986950-1	WASHER, FLAT PRECISION	125			
1	-	B	690701-2	PLATE, SERIAL NO.	123			
1	-	A	4-21028-0	PIN, SLT SPR (Ø.093x.75) ST GDE PL	121			
2	-	A	21899-2	WASHER, FLAT (#10) S G ADJ BLK	119			
2	-	A	21024-5	WASHER, LOCK (#10) ADJ BLOCK	117			
2	-	A	21024-2	WASHER, LOCK (#4) FRONT STP GUIDE	114			
REF	-	A	21024-4	WASHER, LOCK (#8) FEED FINGER	113			
2	-	A	21024-4	WASHER, LOCK (#8) DEP-HOLD	112			
REF	-	A	21024-4	WASHER, LOCK (#8) STRIPPER	111			
1	-	A	21018-5	NUT, HEX (#6) HOLD DOWN	108			
1	-	A	22353-8	SCR, SHLD (Ø.187x.25) DRAG LEVER	105			
1	-	A	21009-2	SCR, 5KT SET (1/4-20x.25 LW) RAM	103			
4	-	A	21017-2	SCR, DRIVE (#2x.19) ID PLATE	101			
1	-	B	819347-1	PLATE, IDENTIFICATION	100			
2	-	A	3-21002-0	SCR, BHC (10-32x.88) DRAG	99			
1	-	A	22733-8	SCR, BHC (8-32x.38 LW) ANVIL	98			
1	-	A	3-21000-8	SCR, SHC (10-32x.88) MOUNTING	96			
1	-	A	2-21002-7	SCR, BHC (10-32x.50) 5G ADJ BLK	95			
4	-	A	2-21002-2	SCR, BHC (8-32x.50) SHEAR-TERM SUP	94			
2	-	A	2-21002-1	SCR, BHC (8-32x.38) SHEAR HOLDER	93			
1	-	A	1-21002-7	SCR, SHC (6-32x.50) CAM	91			
2	-	A	2-21000-7	SCR, SHC (8-32x.50) SCR BLK	90			
REF	-	A	2-21000-7	SCR, SHC (8-32x.48) DEP-HOLD DOWN	87			
REF	-	A	2-22603-0	SCR, HEX HD (8-32x.31) FEED FINGER	86			
2	-	A	1-21000-3	SCR, SHC (4-40x.25) F ST GUIDE	85			
REF	-	A	22733-9	SCR, BHC (8-32x.50 SL) STRIPPER	84			
1	-	A	3-22603-1	SCR, HEX (10-32x.38) 5G ADJ BL	81			
2	-	B	463310-4	BLADE, STRIPPING (#18)	77			
1	-	A	690603-1	SPRING, ASSIST	74			
1	-	A	23030-1	SCR, 5KT CAP (6-32x.25) CP DSC	73			

QTY	REV	TER	APPL	SPEC	FEED	APPL INSTRUCTION	SET UP GAGE	LAYOUT
70								
69								
68								
67								
66								
65								
64								
63								
62								
61								
60								
59								
58								
57								
56								
55								
54								
53								
52								
51								
50								
49								
48								
47								
46								
45								
44								
43								
42								
41								
40								
39								
38								
37								
36								
35								
34								
33								
32								
31								
30								
29								
28								
27								
26								
25								
24								
23								
22								
21								
20								
19								
18								
17								
16								
15								
14								
13								
12								
11								
10								
9								
8								
7								
6								
5								
4								
3								
2								
1								

QTY	REV	TER	APPL	SPEC	FEED	APPL INSTRUCTION	SET UP GAGE	LAYOUT
-1	U/M	DWG SIZE	PART NO	DESCRIPTION	ITEM NO			
PARTS LIST								
REVISION OF EACH ASSY NO (WHEN BLANK, USE DWG REVISION)								
DIMENSIONS IN INCHES. DO NOT SCALE PRINT. TOLERANCES UNLESS OTHERWISE SPECIFIED:								
DR P.MATHIAS 9/22/95 APP 9-25-95 CHK 9-25-95 REL 5/2/97 A.BEDDICK C.ERISMAN B. MORGAN AMP AMP Incorporated Harrisburg, PA 17105-3608 NAME STRIPPER CRIMPER APPLICATOR MACHINE REF STRIPPER CRIMPER SCALE - DWG NO 567913 SHEET 1 OF 1 REV C CASE CODE 00779 CUSTOMER AND ASSEMBLY DRAWING RESTRICTED TO								

THIS DRAWING IS A CONTROLLED DOCUMENT.

THIS DRAWING IS UNRELEASED.
 RELEASED FOR PUBLICATION BY AMP INCORPORATED. ALL RIGHTS RESERVED.
 LOC A
 DIST 66
 AMP 3308 REV 3-92 16-SEP-99 08:09:39 amp18246 7