

## Core **ER42/22/16**

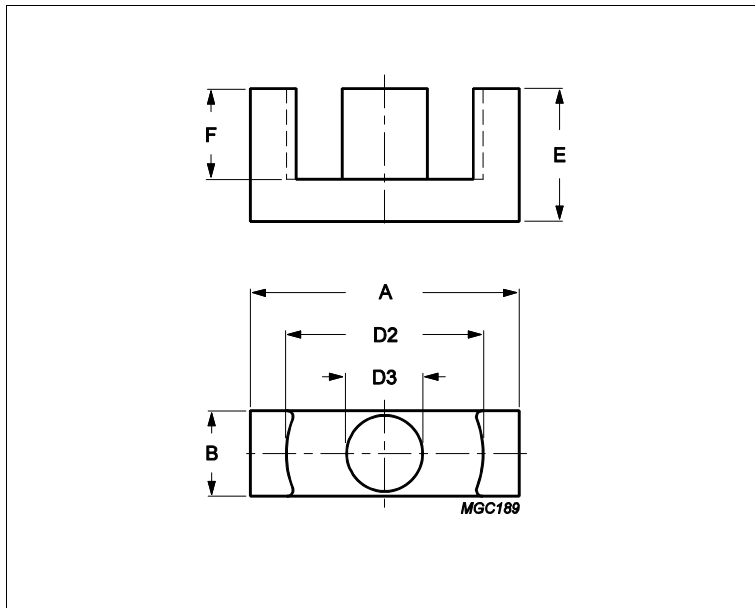

Effective parameters			
	Parameter	Value	Unit
$\Sigma(I/A)$	core factor (C1)	0.509	mm <sup>-1</sup>
<b>Ve</b>	effective volume	19200	mm <sup>3</sup>
<b>Le</b>	effective length	98.8	mm
<b>Ae</b>	effective area	194	mm <sup>2</sup>
<b>Amin</b>	minimum area	189	mm <sup>2</sup>
<b>m</b>	ER42/22/16	≈ 50	g/pcs

Dimensions for product: ER42/22/16						
	Nom	Tol +	Tol -	Max	Min	Unit
<b>A</b>	42.00	0.75	0.75	42.75	41.25	mm
<b>B</b>	15.60	0.40	0.40	16.00	15.20	mm
<b>D2</b>	30.05	0.65	0.65	30.70	29.40	mm
<b>D3</b>	15.50	0.30	0.30	15.80	15.20	mm
<b>E</b>	22.40	0.20	0.20	22.60	22.20	mm
<b>F</b>	15.45	0.35	0.35	15.80	15.10	mm

Inductance factor				
Material	Value	Tol +	Tol -	Unit
3C94	4600	25%	25%	nH/turns <sup>2</sup>

Power loss: 3C94				
Measuring conditions			Max	Unit
100 kHz	200 mT	100 °C	9.600	W/set

Bsat					
Measuring conditions			Material	Min	Unit
25 kHz	250 A/m	100 °C	3C94	320	mT