

THIS DRAWING IS A CONTROLLED DOCUMENT FOR THE COMPANY. IT IS SUBJECT TO CHANGE AND THE COMPANY ASSUMES NO LIABILITY FOR DAMAGE TO PROPERTY OR PERSONS ARISING FROM THE USE OF THIS DRAWING WITHOUT WRITTEN AUTHORIZATION FROM AMP INCORPORATED, HARRISBURG, PA.

THIS INFORMATION IS UNCLASSIFIED AND IS TO BE RELEASED TO ANYONE REQUESTING IT WITHOUT WRITTEN AUTHORIZATION FROM AMP INCORPORATED, HARRISBURG, PA.

AMP INCORPORATED
HARRISBURG, PA.

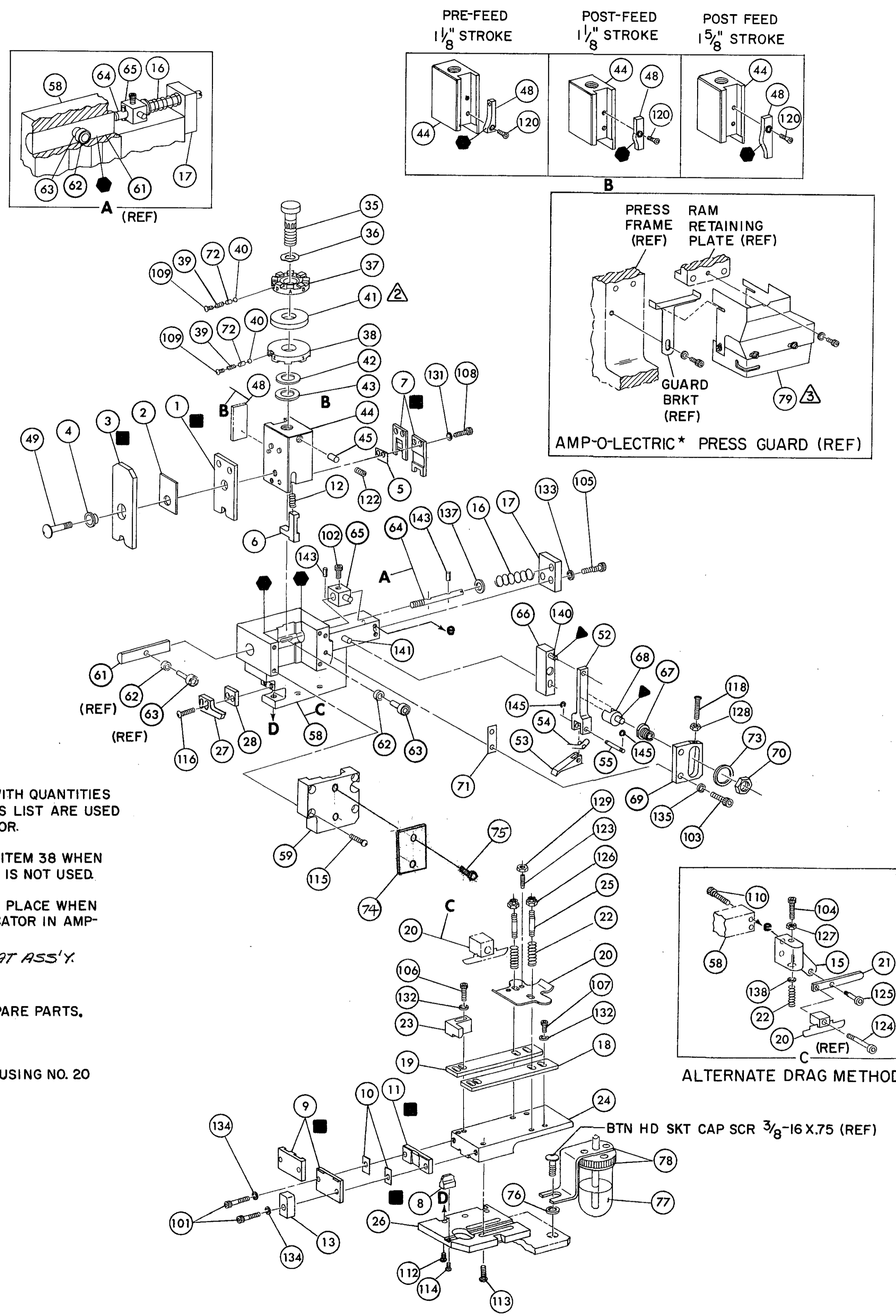

- NOTES:**
- 1. ONLY THE ITEMS WITH QUANTITIES SPECIFIED ON PARTS LIST ARE USED ON THIS APPLICATOR.
 - ▲ USED IN PLACE OF ITEM 38 WHEN INSULATION CRIMP IS NOT USED.
 - ▲ GUARD MUST BE IN PLACE WHEN OPERATING APPLICATOR IN AMP-O-LECTRIC PRESS.
 - ▲ CUT TO LENGTH AT ASS'Y.
- KEY:**
- RECOMMENDED SPARE PARTS.
 - ▲ LUBRICATE DAILY USING NO. 20 MACHINE OIL.
 - GREASE LIGHTLY.

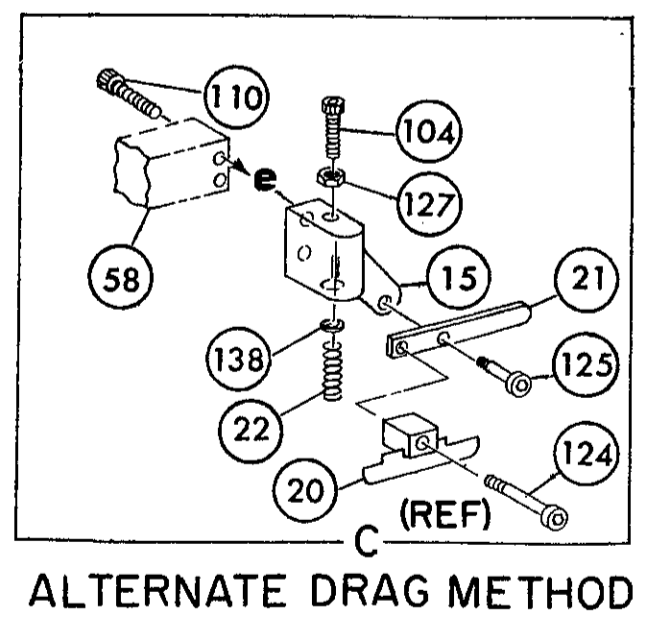

QTY	PART NO	DESCRIPTION	ITEM NO	QTY	PART NO	DESCRIPTION	ITEM NO
REF.	21045-3	RING, RETAINING 'C' (.187 DIA) FEED PIN	145	REF.	454220-1	CAP, RAM	59
REF.	5-21028-1	PIN, SLOT SPG (.12 DIA X .50) FD ADJ ROD	144	REF.	453736-1	HOUSING	58
REF.	1-21030-7	PIN, DOWEL (.187 DIA X 1.50) HOUSING	142				57
REF.	1-21030-1	PIN, DOWEL (.187 DIA X .50) LEVER	141	REF.	240624-1	PIN, FEED FINGER	56
	22260-5	WASHER, FLAT (NO 6) DRAG SPRING	140	REF.	691499-1	SPRING, FEED FINGER	55
REF.	21899-4	WASHER, FLAT (5/16 DIA) SCR ADJ	139	REF.	240635-1	FINGER, FEED	54
			138	REF.	240634-1	LEVER, TERMINAL	53
			137				52
			136				51
REF.	21024-5	WASHER, LOCK (NO 10) FEED ADJ PLATE	135	1	7-21002-9	BOLT, CRIMPER	50
2	21024-5	WASHER, LOCK (NO 10) SHEAR PLATES	134	1	690501-4	CAM, POST-FEED 1 5/8 STROKE	49
REF.	21024-5	WASHER, LOCK (NO 10) FEED ROD GUIDE	133				48
5	21024-4	WASHER, LOCK (NO 8) STRIP GUIDE	132				47
2	21024-4	WASHER, LOCK (NO 8) SHEAR BLADE	131	1	690191-1	PLUG, NYLON	46
			130	1	453674-2	RAM	45
2	21018-4	NUT, HEX MACH (4-40) DRAG	129	1	690125-1	WASHER, LAMINATED	44
REF.	21068-5	NUT, HEX MACH (6-32) FD ADJ PLATE	128	1	690124-1	WASHER, RAM	43
	21018-7	NUT, HEX MACH (10-32) DRAG SPRING	127			SPACER, DISC	42
2	21022-2	NUT, HEX SELF-LKG (8-32) DRAG STUD	126	2	23241-6	BALL, STEEL	41
	5-21004-7	SCR, SKT HD SHLD (250 DIA X .25) DRAG ARM	125	2	690170-1	SPRING, COMPRESSION	40
	21004-5	SCR, SKT HD SHLD (250 DIA X 1.00) DRAG	124	1	690142-1	DISC, INSULATION	39
2	4-21078-8	SCR, SKT SET OVAL POINT (4-40 X .75) DRAG	123	1	5-690692-2	DISC, WIRE	38
1	21009-2	SCR, SKT SET (1/4-20 X 25) (LOC-WEL) RAM	122	1	22480-5	WASHER, SPRING	37
			121	1	690212-1	POST, RAM	36
1	1-21002-7	SCR, BTN HD SKT CAP (6-32 X .38) CAM	120				35
			119				34
REF.	3-21064-2	SCR, RD HD MACH (6-32 X 1.50) FEED ADJ	118	1	458980-1	APPLICATOR, BASIC (SUB ASSY)	33
			117				32
2	2-21002-2	SCR, BTN HD SKT CAP (8-32 X .50) STRIPPER	116				31
REF.	2-21002-9	SCR, BTN HD SKT CAP (10-32 X .75) HSG CAP	115				30
1	22733-8	SCR, BTN HD SKT CAP (8-32 X .38) (LOC-WEL) ANVIL	114	1	1-690451-7	SPACER, STRIPPER	29
4	3-21002-3	SCR, BTN HD SKT CAP (1/4-20 X .50) STR GDE PL	113	1	240639-1	STRIPPER	28
REF.	2-22733-9	SCR, BTN HD SKT CAP (1/4-20 X .75) BASE PL	112	REF.	455676-1	PLATE, BASE	27
			111	2	22354-8	DRAG, STUD	26
	2-21000-4	SCR, SKT HD CAP (6-32 X 1.00) DRAG ADAPTOR	110	1	453678-6	PLATE, STRIP GUIDE	25
2	2-3030-1	SCR, SKT HD CAP (6-32 X .25) (LOC-WEL) CP DISC	109	1	240825-7	PLATE, STRIP HOLD	24
2	2-21000-8	SCR, SKT HD CAP (8-32 X .60) SHEAR BLADE	108	2	4-22281-1	SPRING, DRAG	23
3	2-21000-6	SCR, SKT HD CAP (8-32 X .38) STRIP GUIDE	107		240636-1	LEVER, DRAG	22
2	2-21000-9	SCR, SKT HD CAP (8-32 X .25) STRIP GUIDE	106	1	454177-1	DRAG, STOCK	21
REF.	3-21000-7	SCR, SKT HD CAP (10-32 X .75) FD ROD GUIDE	105	1	454204-1	GUIDE, STRIP (REAR)	20
	3-21000-9	SCR, SKT HD CAP (10-32 X 1.00) DRAG SPRING	104	1	454204-1	GUIDE, STRIP (FRONT)	19
REF.	3-21000-6	SCR, SKT HD CAP (10-32 X .62) FD ADJ PLATE	103	REF.	454178-1	GUIDE, FEED ROD	18
REF.	3-21000-4	SCR, SKT HD CAP (10-32 X .38) PIVOT BLK	102	REF.	4-22284-9	SPRING, FEED RETURN	17
2	3-21000-8	SCR, SKT HD CAP (10-32 X .88) SHEAR PLATE	101	REF.		ADAPTER, DRAG	16
REF.	455745-1	GUARD, WINDOW	79				15
	465184-9	LUBRICATOR ASSY	78			SPACER, HOLD DOWN	14
	455985-1	OIL, LUBRICATING	77			SPRING, HOLD DOWN	13
	454406-1	SPACER, LUB BRACKET	76	1	1-240644-1	PLATE, REAR SHEAR	12
2	21017-2	SCREW, DRIVE (# 2 X .19) I.D. PLATE	75	2	5-240645-0	SPACER, SHEAR PLATE	11
1	461264-1	PLATE, IDENTIFICATION	74	1	240642-8	PLATE, FRONT SHEAR	10
REF.	458109-1	WASHER, FLAT (SPECIAL)	73	1	7-238005-4	ANVIL	9
2	690603-1	SPRING, ASSIST	72	1	5-240651-8	BLADE, SLUG	8
REF.	690517-1	SPACER	71			HOLD DOWN, TERMINAL	7
	22594-8	NUT, HEX	70	1	3-240641-3	SPACER, SHEAR BLADE	6
	240628-1	PLATE, ADJ	69	1	1-238009-4	SPACER, TUBULAR	5
	240626-1	SHAFT, PIVOT	68	1	4-456134-B	CRIMPER, INSULATION	4
	240633-1	BUSHING	67	1	455888-5	SPACER, INSULATION	3
	455680-1	LEVER, INTERMEDIATE	66	1	458141-7	CRIMPER, WIRE	2
	240629-1	BLOCK, PIVOT	65				1
	240632-2	SCREW, ADJ	64				
	240659-3	PIN, CAM ROLLER	63				
	240658-1	CAM, ROLLER	62				
REF.	454398-1	ROD, FEED	61				
			60				

REMARKS		NO	REV
APPL USED ON MACHINE PART NO		TO APPLY TERMINAL	
CUSTOMER NAME	APPL SERIAL NO	DISTRIBUTION	
ADDRESS	PURCHASE ORDER	ORIGINAL	1
CITY	ENG APP	CUSTOMER COPY	2
		FIELD ENG COPY	4

QTY	PART NO	DESCRIPTION	ITEM NO
		CRIMPING DATA	
		PAD LTR	CRIMP HEIGHT
		WIRE SIZE	WIRE STRIP LENGTH
		A	.039 22
		B	.037 24
		C	.035 26
		D	NOT USED
		CRIMP SIZE	TYPE
		FEED	APPL INST
		WIRE RANGE	INSULATION RANGE
		20-22	.055-.080
		REMARKS	POST-FEED AMPOMATOR

AMP INCORPORATED
HARRISBURG, PA.

SET UP PAGE 10-1
453638-1 913

DR 9-2-76 APP 1/1/14
0150-GAAS-95
SC-A-1934-89
REV 1/2/81
REV DER R3191

NO 466613-1

MINIATURE QUICK CHANGE APPLICATOR

END FEED (WELD TAB)