

PCB LAYOUT (CONNECTOR) / TOP VIEW

NOTE:
 MECHANICAL:
 CONNECTOR MATERIAL:
 1. HOUSING: HIGH TEMPERATURE THERMOPLASTIC
 GLASS FIELD. UL94V-0.
 :STANDARD COLOR :BLACK.
 2. CONTACT: PHOS-BRONZE THICKNESS=0.20mm.
 : SELECTIVE GOLD PLATING 30u"
 3. DURABILITY: 250 CYCLES MIN.
 ELECTRICAL:
 1. VOLTAGE RATING : 30 VAC RMS MAX.
 2. CURRENT RATING : 0.5 AMP MAX.
 3. DIFFERENTIAL IMPEDANCE : 100 Ohms.
 4. CAPACITANCE: 1.2pF MAX.
 5. CONTACT RESISTANCE: 20 MILLIOHMS MAX.
 6. INSULATION RESISTANCE: 500 MEGAOHMS MIN.
 7. TEMPERATURE:
 OPERATING: -55°C to +85°C
 STORAGE: -55°C to +85°C
 IR REFLOW PEAK SOLDER TEMPERATURE SUGGEST 250°C~270°C.
 8. RoHS COMPLIANT.

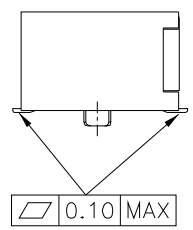
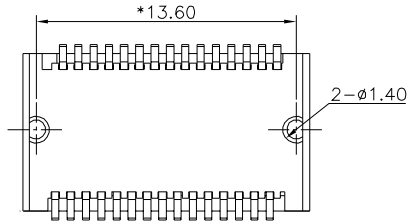
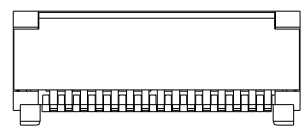
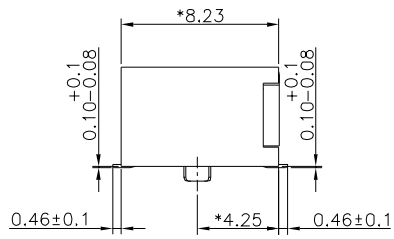
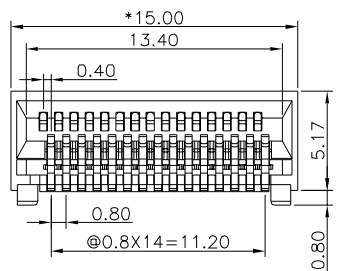

PART NUMBER
E81N0-YCUDF4-L

DETACHED LISTS	MM (INCH)		RoHS Compliant			
	TOLERANCES EXCEPT AS NOTED					
	MM					
.0	± 0.2					
.00	± 0.15					
.000	± 0.075					
ANGLES ± 0.5						
THIRD ANGLE PROJECTION		TITLE XFP CONNECTOR 30 PIN				
DFTO Colthy		DRAWING NO. CE813038-LA		SIZE	REV	
DATE 08/10/2006		/PART NO. SEE TABLE		A3	0	
SCALE : 4:1				DO NOT SCALE DRAWING		
				SHEET 1	OF 1	