

Housing - HC-B 16-KMQ-H-O1STM40 - 1414349

Please be informed that the data shown in this PDF Document is generated from our Online Catalog. Please find the complete data in the user's documentation. Our General Terms of Use for Downloads are valid (<http://phoenixcontact.com/download>)



HEAVYCON B16 coupling housing, with double locking latch, height: 82 mm, with 1 x M40 thread, straight cable outlet



Key Commercial Data

Packing unit	1 pc
Weight per Piece (excluding packing)	240.0 g
Custom tariff number	85389099
Country of origin	Germany

Technical data

Dimensions

Height	82 mm
--------	-------

Ambient conditions

Degree of protection	IP65
Ambient temperature (operation)	-40 °C ... 125 °C

General

Note	For contact inserts HC-B16, BB32, BBB40, D40, DD72, HS6, M, K
Type	B16
Degree of protection	IP65
Locking type	With double locking latch
Type of the screw connection	1x M40
Pg screw connection	none
Cable exit	straight
Housing material	Aluminum die-cast
Housing surface material	Powder-coated, gray
Seal material	NBR

Housing - HC-B 16-KMQ-H-O1STM40 - 1414349

Technical data

General

Ambient temperature (operation)	-40 °C ... 125 °C
---------------------------------	-------------------

Classifications

eCl@ss

eCl@ss 5.1	27143424
eCl@ss 6.0	27143424

Approvals

Approvals

Approvals

EAC

Ex Approvals

Approvals submitted

Approval details

EAC

Drawings

Dimensional drawing

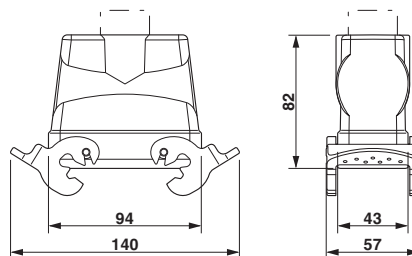

Dimensional drawing
