

LOC	DIST	REVISIONS			
GP	00	REV	DATE	BY	APPD
		A	26APR2011	TX	CW

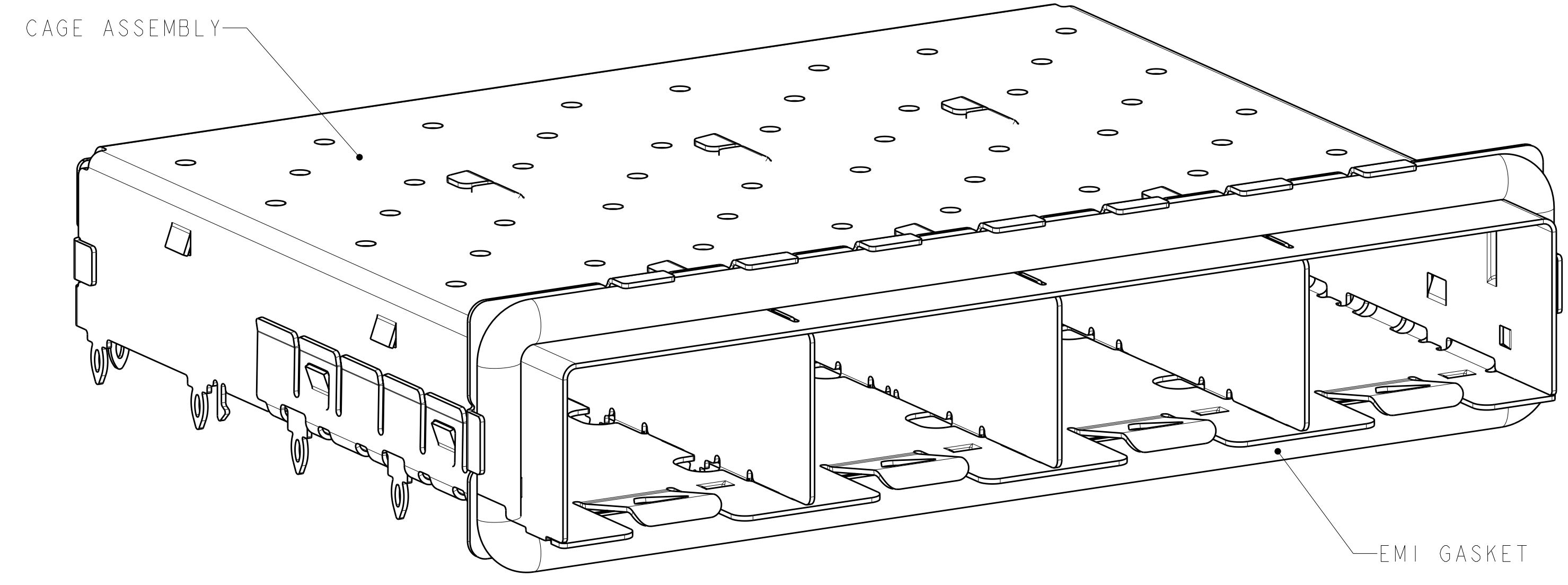

2057833-1  
FINISHED ASSEMBLY

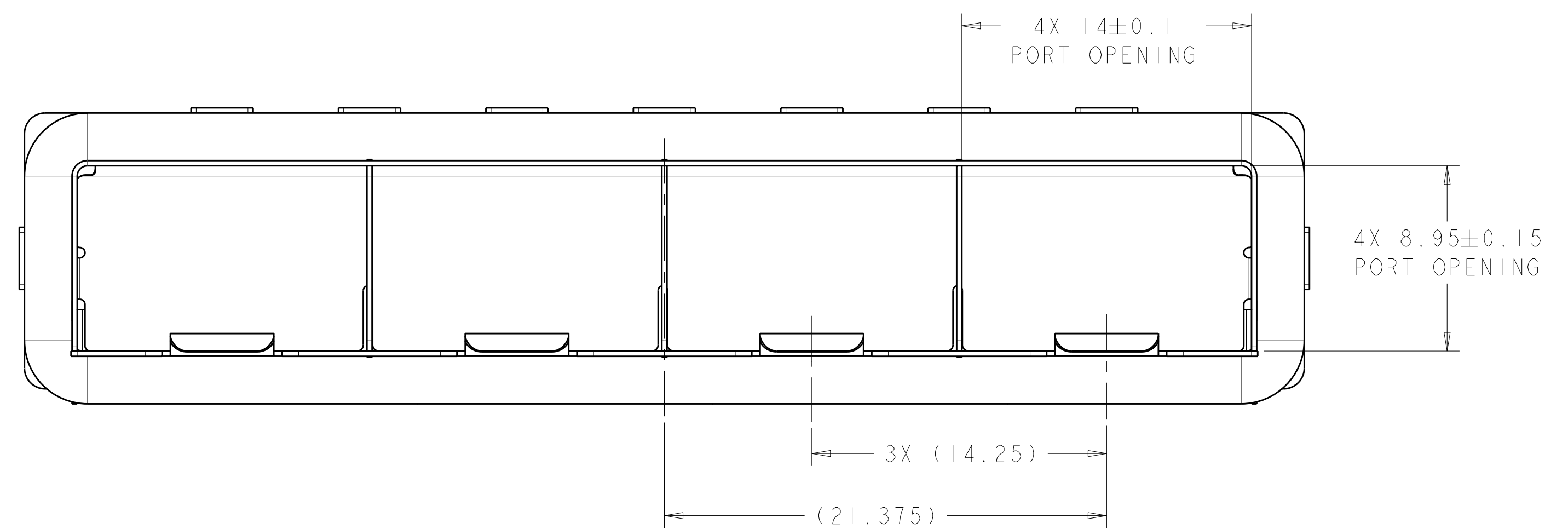
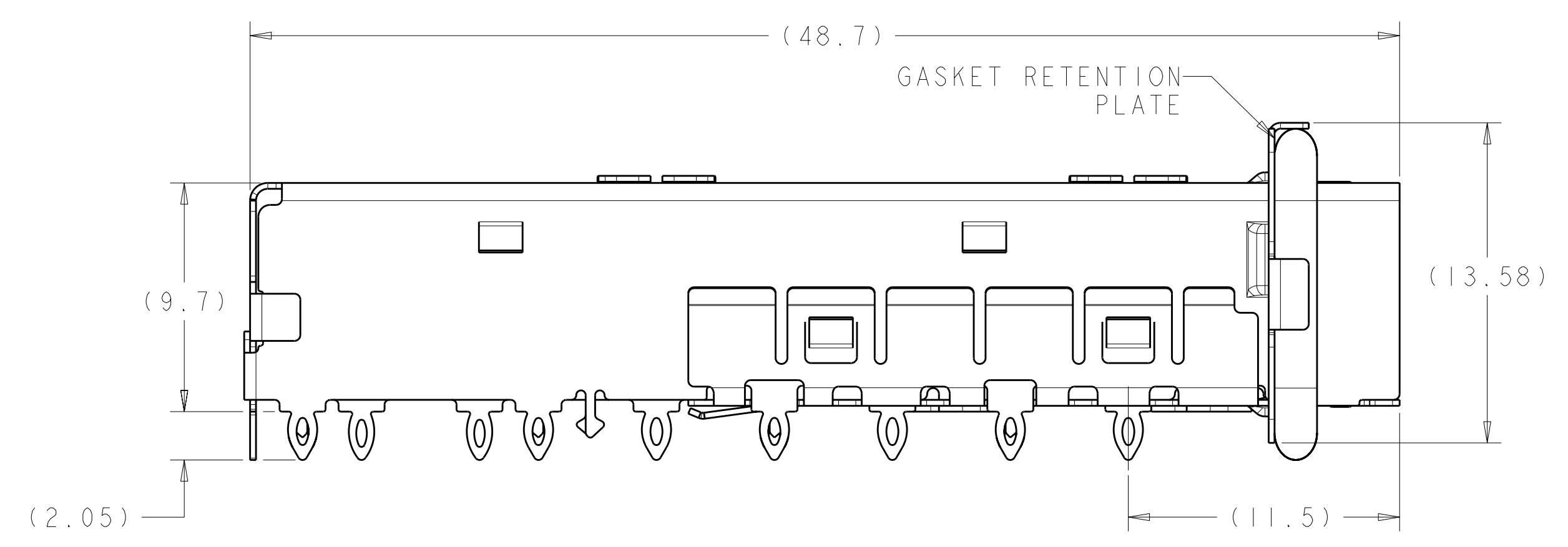

- 1. MATERIAL:  
 CAGE ASSEMBLY: NICKEL SILVER ALLOY  
 GASKET RETENTION PLATE: STAINLESS STEEL  
 GASKET: PLATED FILLED SILICONE
- 2. MINIMUM PC BOARD THICKNESS:  
 SINGLE SIDED = 1.50  
 DOUBLE SIDED = 3.00
- 3. PADS AND VIAS CHASSIS GROUND.
- 4. DATUM AND BASIC DIMENSION ESTABLISHED BY CUSTOMER.
- 5. MATES WITH SFP MSA COMPLIANT TRANSCEIVERS.
- 6. INTERPRETATION OF DATUM REFERENCE FRAME IN ACCORDANCE WITH SECT 4.4.1.1 OF ASME Y14.5M-1994.
- 7. REFERENCE APPLICATION SPEC. 114-13120, HOLE A, FOR RECOMMENDED DRILL HOLE DIAMETER AND PLATING THICKNESS.
- 8. REFERENCE APPLICATION SPEC. 114-13120, HOLE B, FOR RECOMMENDED DRILL HOLE DIAMETER AND PLATING THICKNESS.
- 9. HOLE PATTERN REPEATS FOR EACH PORT. SPACING BETWEEN PORTS IS 14.25mm.

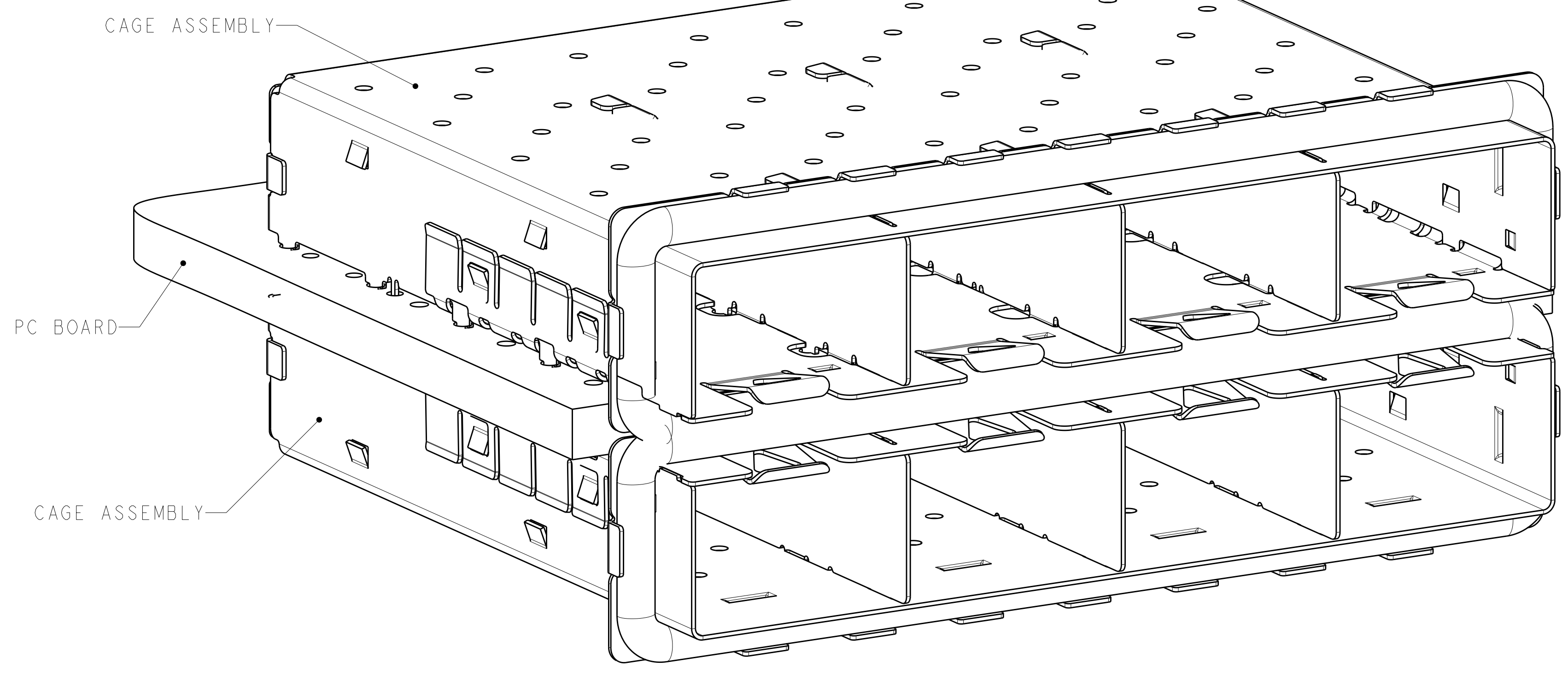

2057833-1  
MOUNTED BELLY TO BELLY ON PCB  
SCALE 5:1

2057833-1  
PART NUMBER

THIS DRAWING IS A CONTROLLED DOCUMENT.		DWN J. POLIGNONE 21NOV08	TE Connectivity	
DIMENSIONS:		CHK M. SCHMITT 21NOV08		
TOLERANCES UNLESS OTHERWISE SPECIFIED:		APVD M. SCHMITT 21NOV08		
mm		PRODUCT SPEC		
0 PLC ±0.1 1 PLC ±0.1 2 PLC ±0.1 3 PLC ±0.1 4 PLC ±0.1 ANGLES ±0.1		NAME 108-2364		
MATERIAL		APPLICATION SPEC	1x4 SFP+ ENHANCED, CAGE ASSEMBLY PRESS FIT, BELLY TO BELLY	
FINISH		114-13120	SIZE CAGE CODE DRAWING NO	
		WEIGHT	A100779C=2057833	
CUSTOMER DRAWING		SCALE 4:1	SHEET 1 OF 4 REV A	

LOC	DIST	REV	DATE	BY	APPV
GP	00				

REVISIONS		DATE	BY	APPV
1	SEE SHEET 1	-	-	-

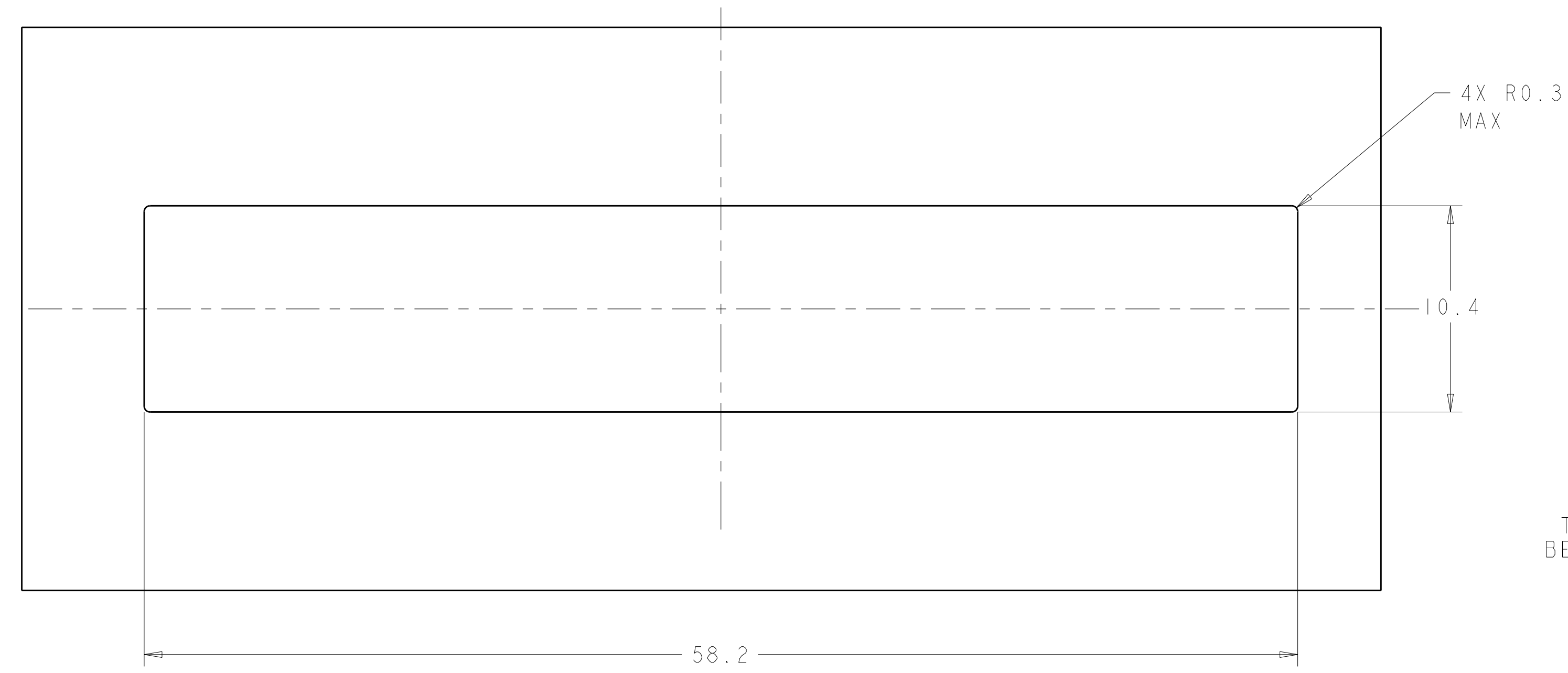

RECOMMENDED BEZEL CUT-OUT  
 SINGLE SIDED APPLICATIONS  
 SCALE 5:1

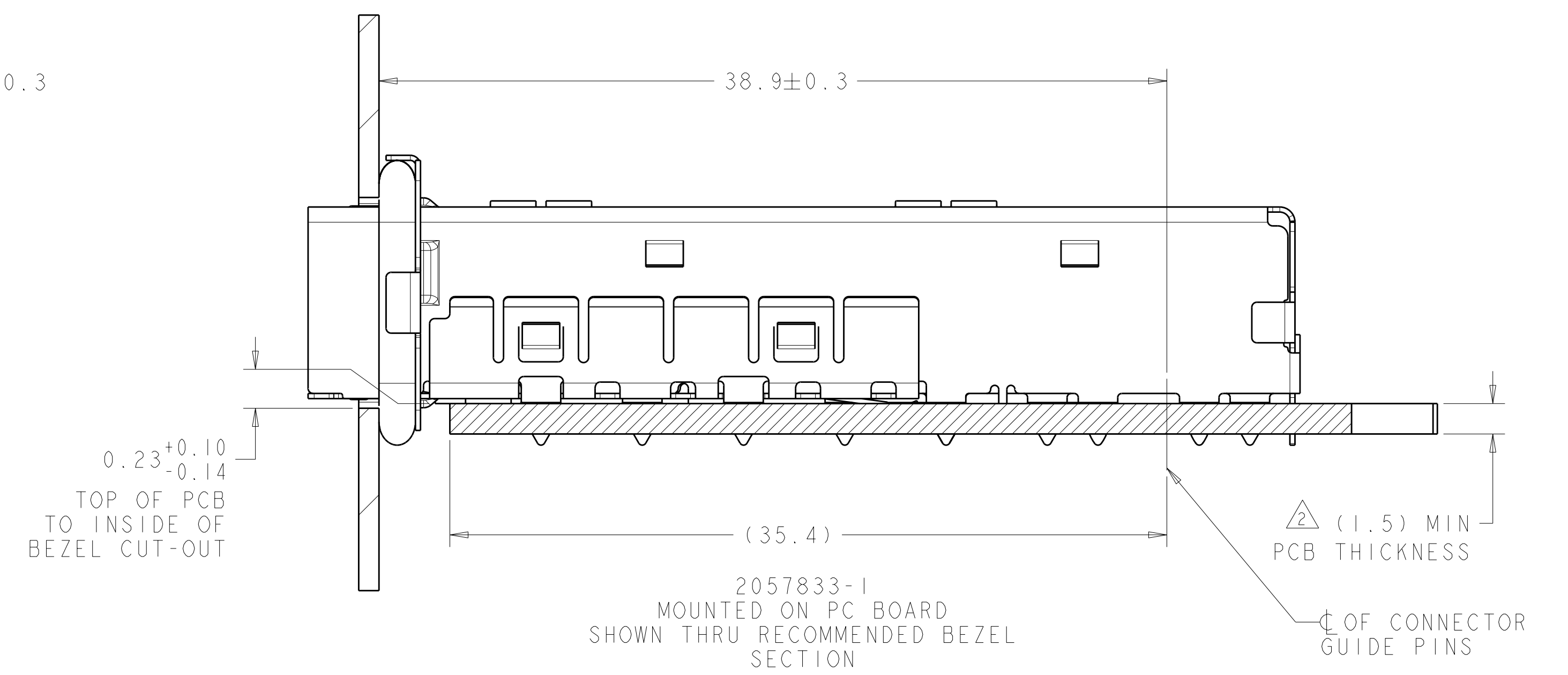

2057833-1  
 MOUNTED ON PC BOARD  
 SHOWN THRU RECOMMENDED BEZEL  
 SECTION

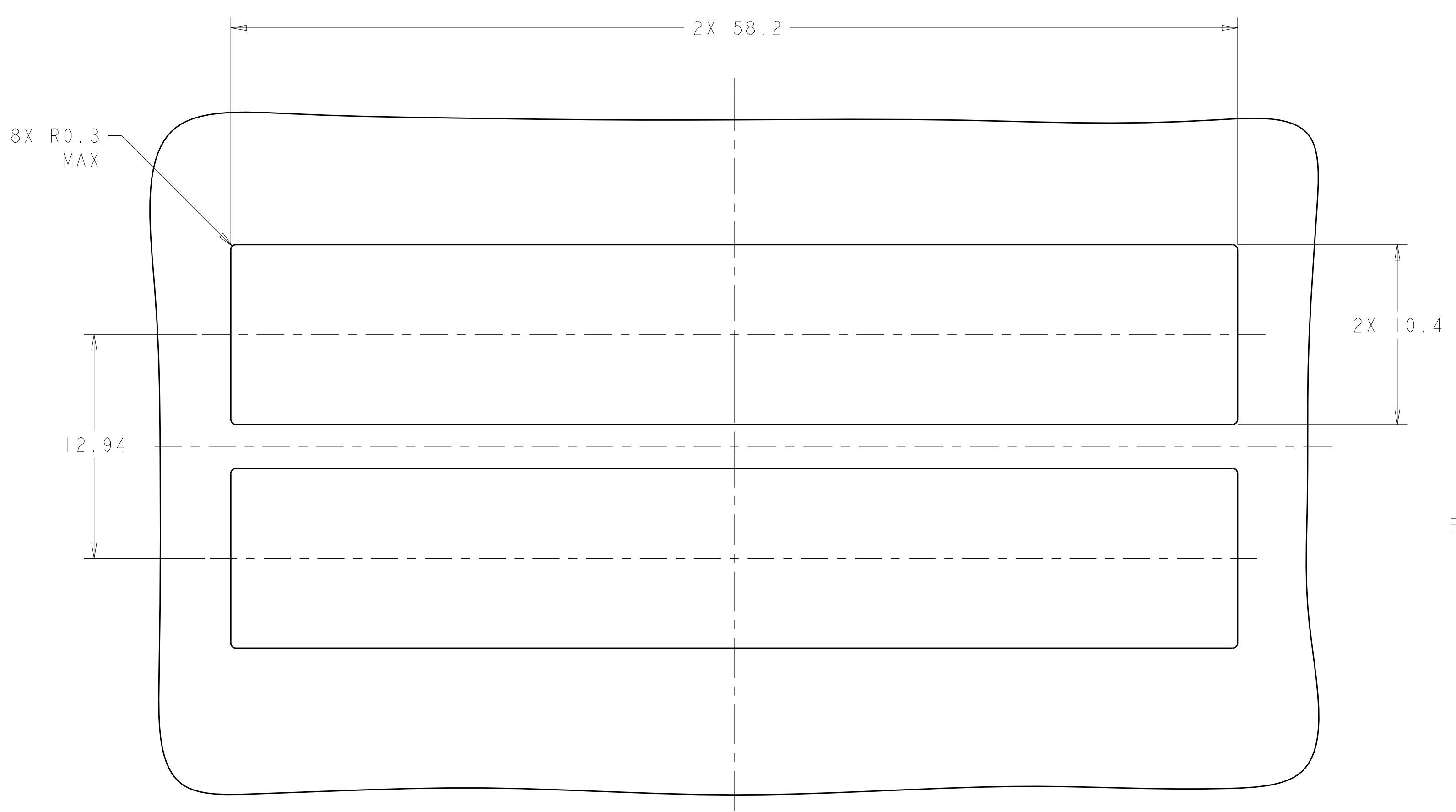

RECOMMENDED BEZEL CUT-OUT  
 BELLY TO BELLY APPLICATIONS  
 SCALE 5:1

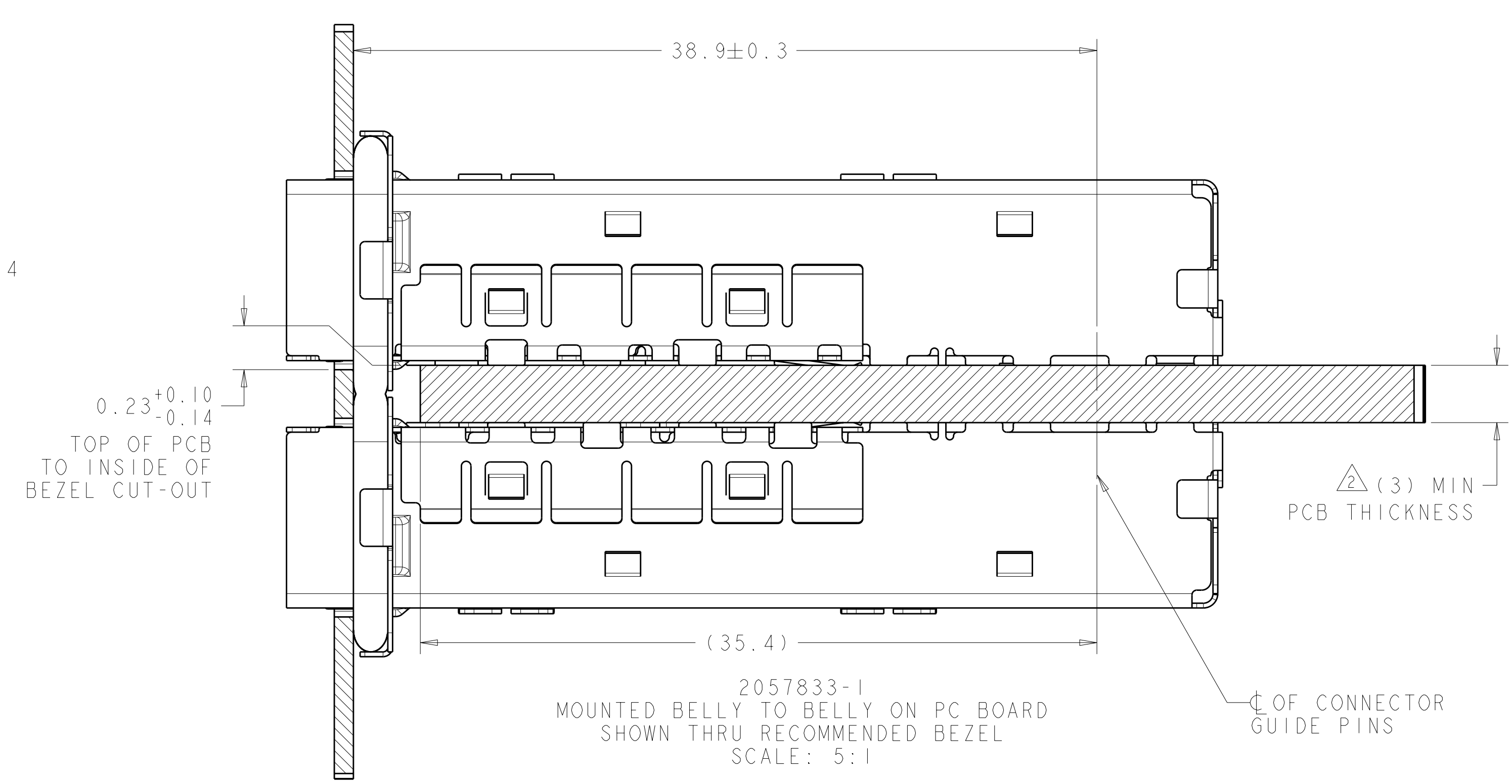

2057833-1  
 MOUNTED BELLY TO BELLY ON PC BOARD  
 SHOWN THRU RECOMMENDED BEZEL  
 SCALE: 5:1

THIS PRINT IS  
**PRELIMINARY**  
 UNQUALIFIED PRODUCT  
 CONTACT PRODUCT ENGINEERING  
 BEFORE USING THIS PRINT

THIS DRAWING IS A CONTROLLED DOCUMENT.		DWN: J. POLIGNONE 21NOV08 CHK: M. SCHMITT 21NOV08 APPV: M. SCHMITT 21NOV08	TE Connectivity
DIMENSIONS: mm	TOLERANCES UNLESS OTHERWISE SPECIFIED: 9 PLC ±0.1 3 PLC ±0.1 5 PLC ±0.1 4 PLC ±0.1 ANGLES ±0.1 FINISH #1	PRODUCT SPEC: 108-2364 APPLICATION SPEC: 114-13120 WEIGHT: - CUSTOMER DRAWING	

LOC	DIST	REV	DESCRIPTION	DATE	DWN	APVD
GP	00		SEE SHEET 1			

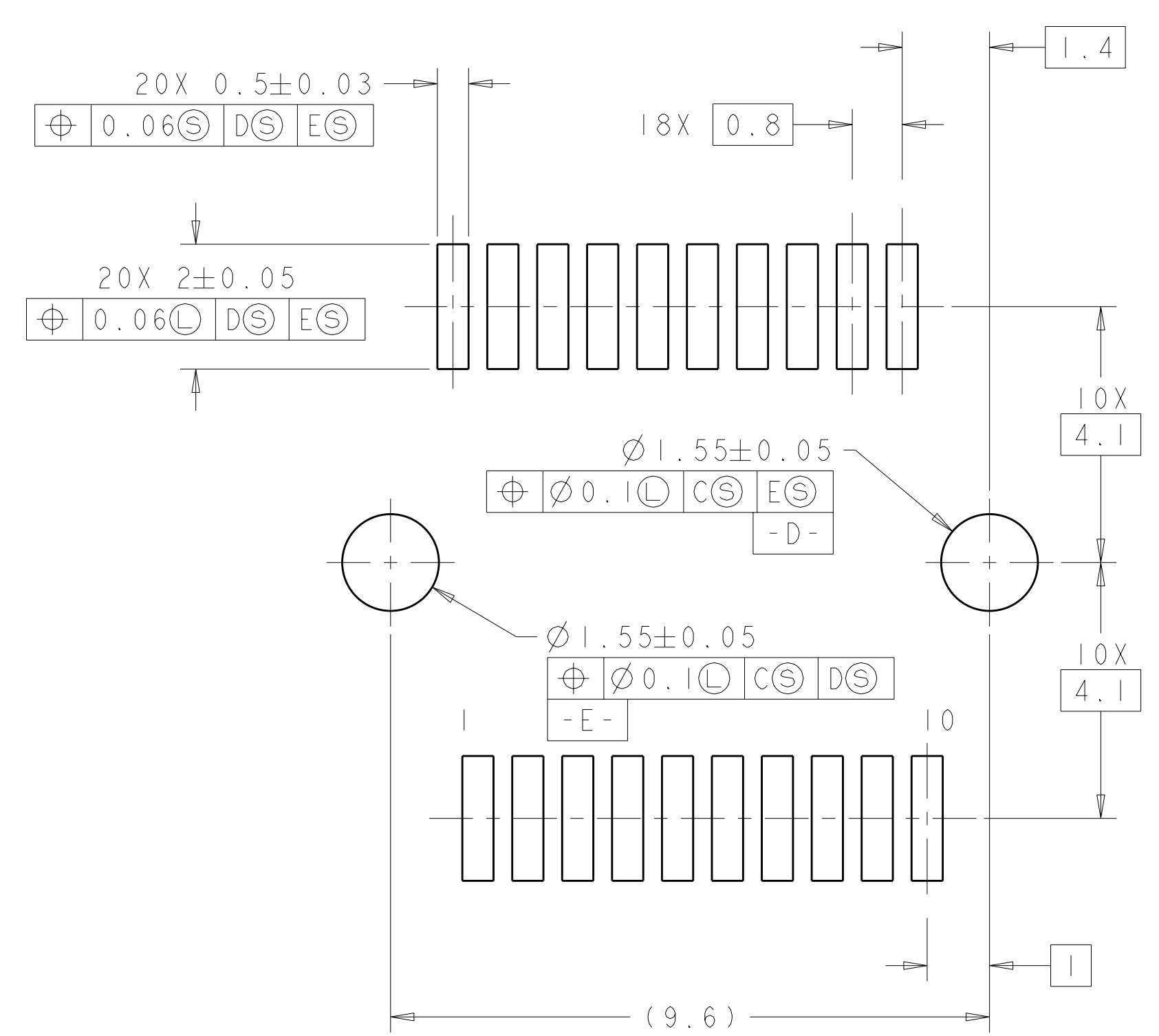
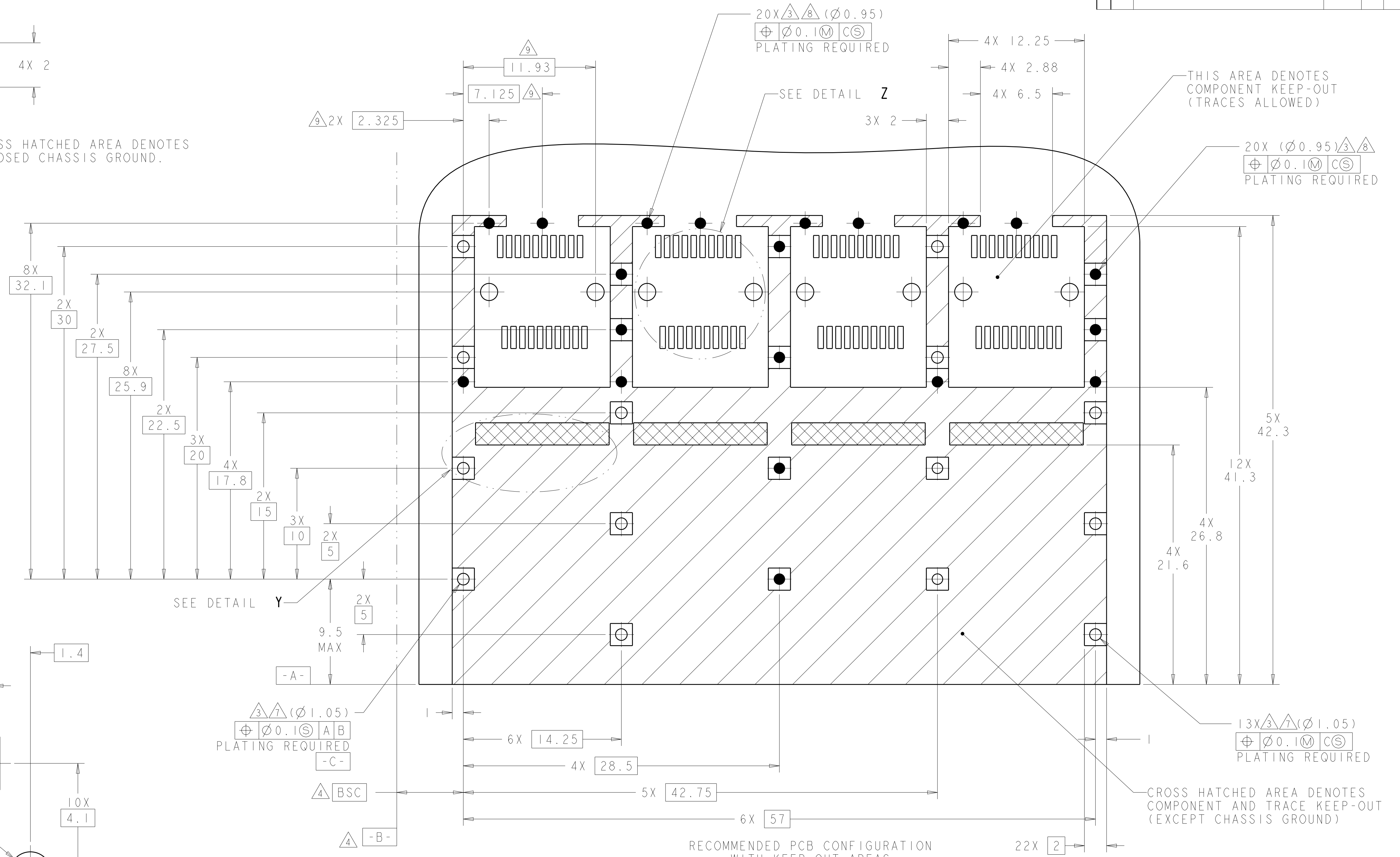
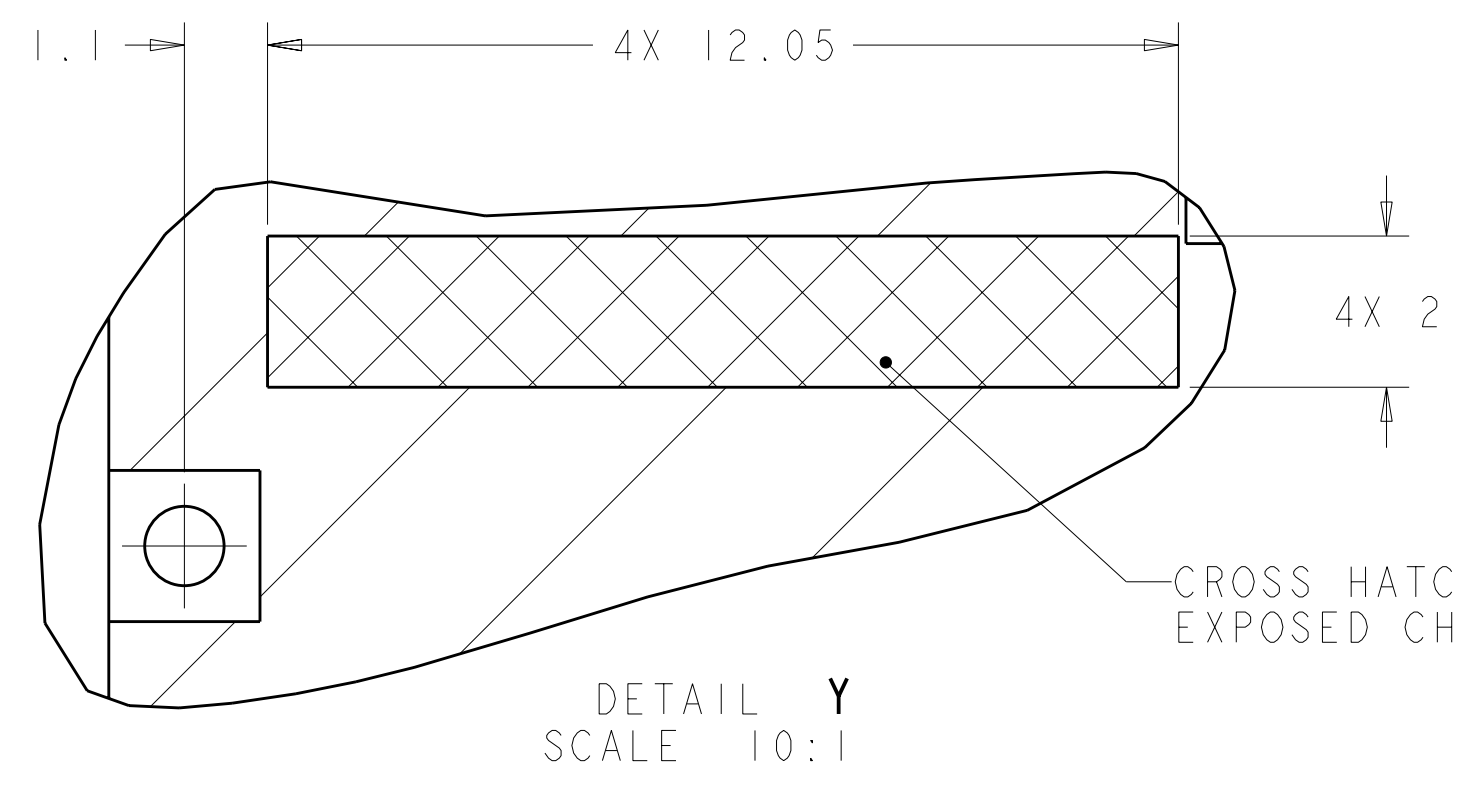

THIS DRAWING IS A CONTROLLED DOCUMENT.		DWN J. POLIGNONE	21NOV08	TE Connectivity
DIMENSIONS: mm		CHK M. SCHMITT	21NOV08	
TOLERANCES UNLESS OTHERWISE SPECIFIED:		APVD M. SCHMITT	21NOV08	NAME 1x4 SFP+ ENHANCED, CAGE ASSEMBLY PRESS FIT, BELLY TO BELLY
9 PLC $\pm$ 0.1 1 PLC $\pm$ 0.1 5 PLC $\pm$ 0.1 4 PLC $\pm$ 0.1 ANGLES $\pm$ 0.1		PRODUCT SPEC 108-2364	APPLICATION SPEC 114-13120	SIZE CAGE CODE DRAWING NO A100779C=2057833
MATERIAL FINISH		WEIGHT	CUSTOMER DRAWING	RESTRICTED TO
		SCALE 4:1	SHEET 3 OF 4	REV A

LOC	DIST	REVISIONS			
GP	00	REV	DATE	BY	APPD
		1			
		2			
		3			
		4			
		5			
		6			
		7			
		8			
		9			
		10			

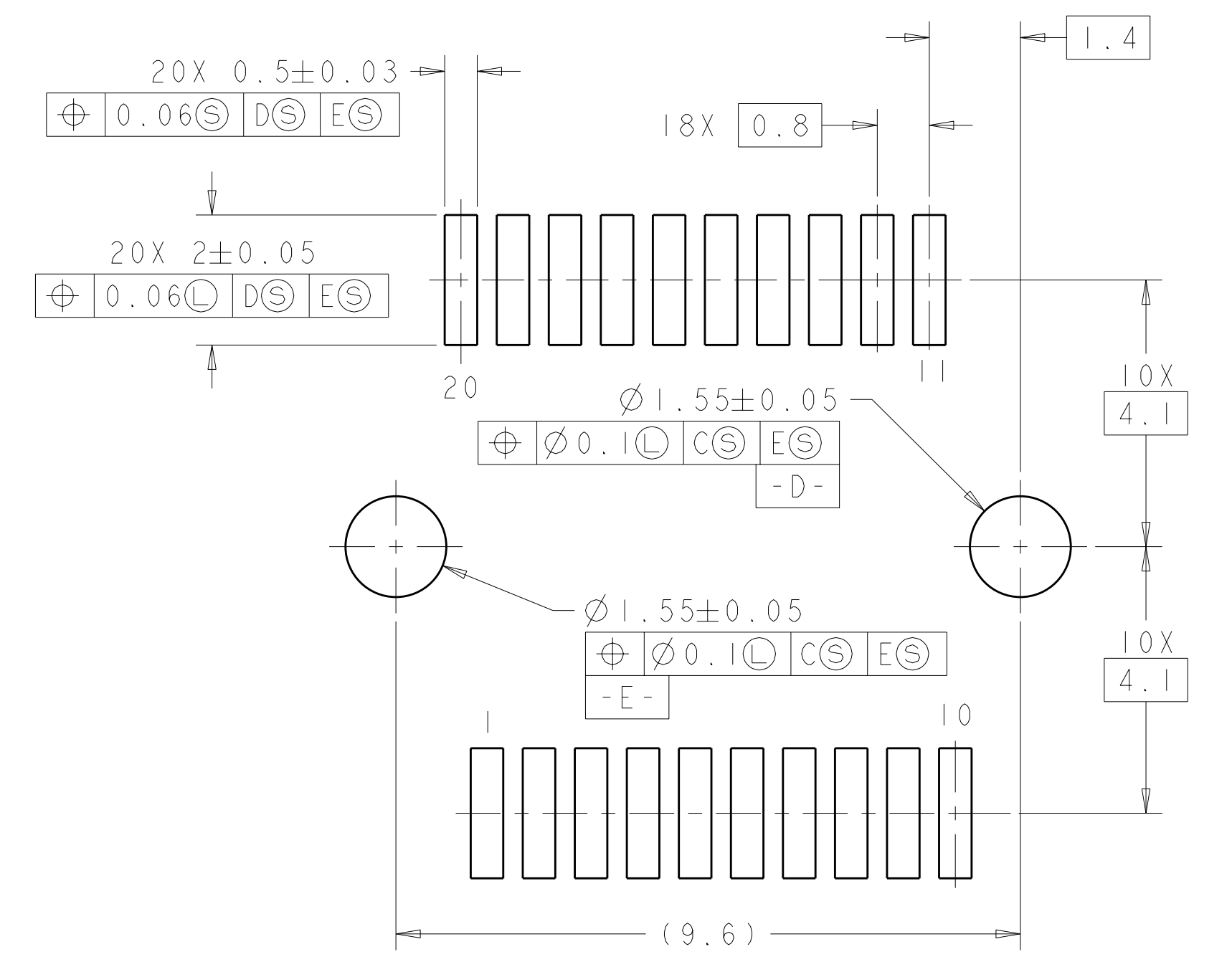
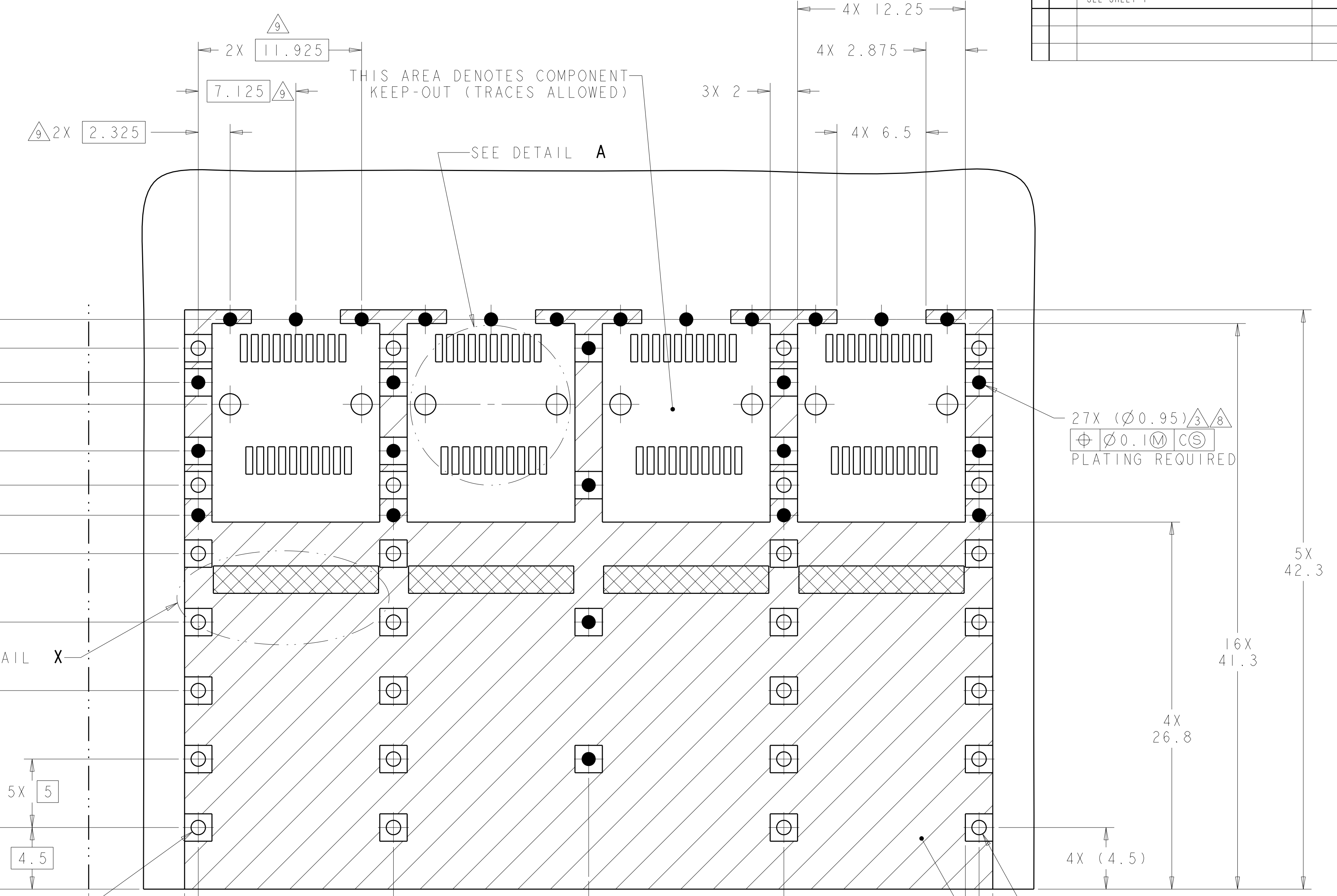
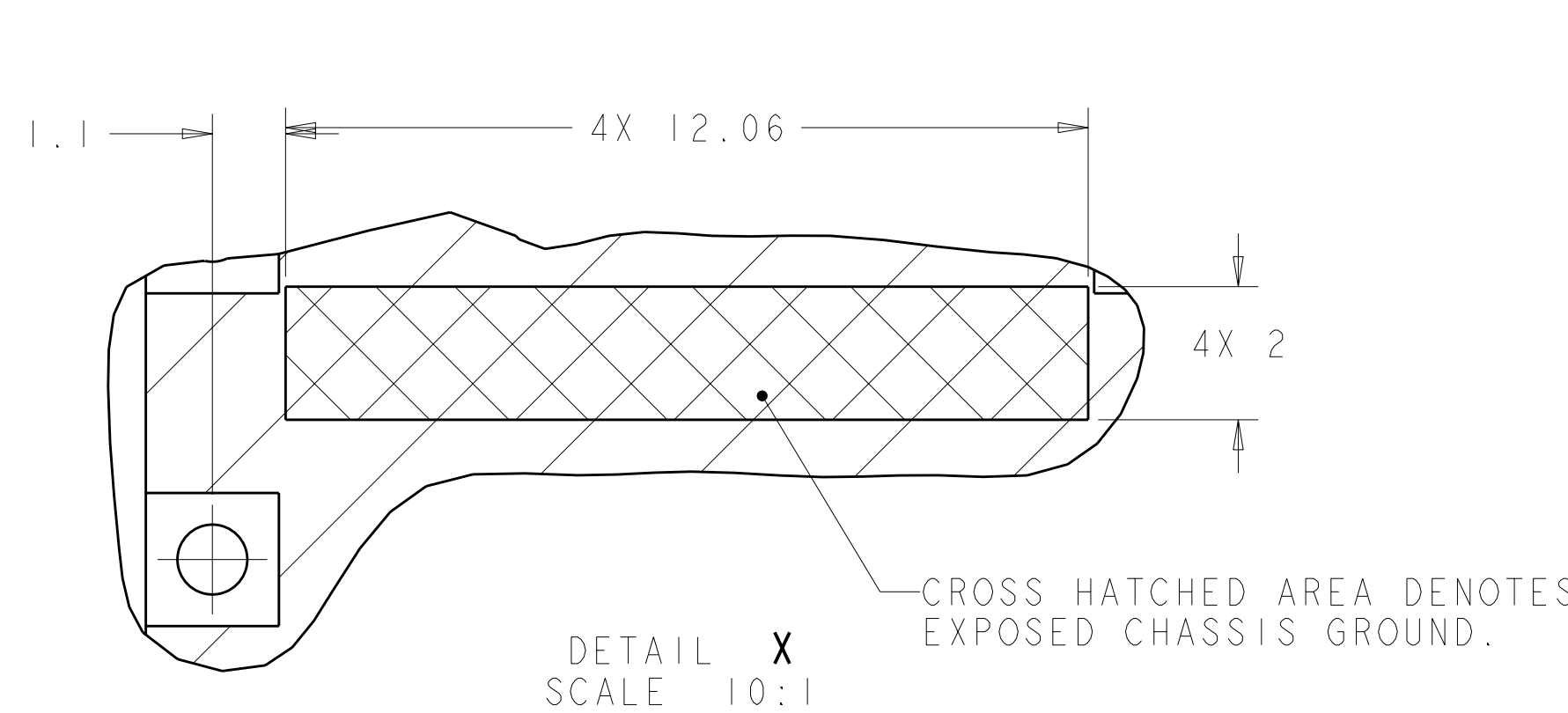

RECOMMENDED PCB CONFIGURATION WITH KEEP-OUT AREAS BELLY TO BELLY APPLICATIONS SCALE 5:1

THIS DRAWING IS A CONTROLLED DOCUMENT.		DWN J. POLIGNONE 21NOV08	TE Connectivity
DIMENSIONS: mm		CHK M. SCHMITT 21NOV08	
TOLERANCES UNLESS OTHERWISE SPECIFIED:		APVD M. SCHMITT 21NOV08	NAME: 1x4 SFP+ ENHANCED, CAGE ASSEMBLY PRESS FIT, BELLY TO BELLY
9 PLC ±0.1		PRODUCT SPEC: 108-2364	
1 PLC ±0.1		APPLICATION SPEC: 114-13120	SIZE: CAGE CODE DRAWING NO: A100779C=2057833
5 PLC ±0.1		WEIGHT: -	
4 PLC ±0.1		FINISH: -	SCALE: 4:1 SHEET 4 OF 4 REV A
ANGLES ±0.1		CUSTOMER DRAWING	