

PRODUCT NUMBER	PITCH
YK552xx0x0JOG	11.00 mm

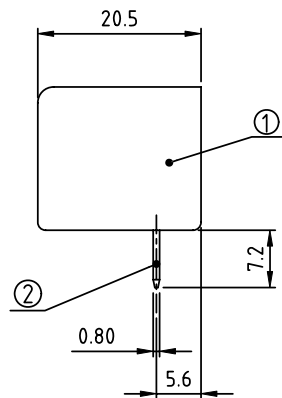
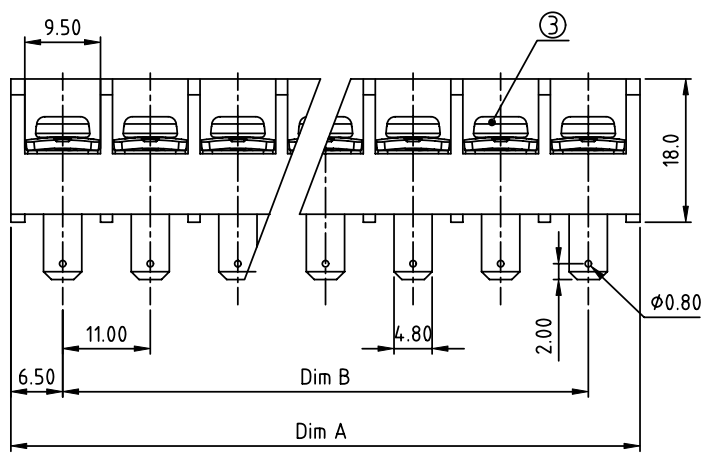
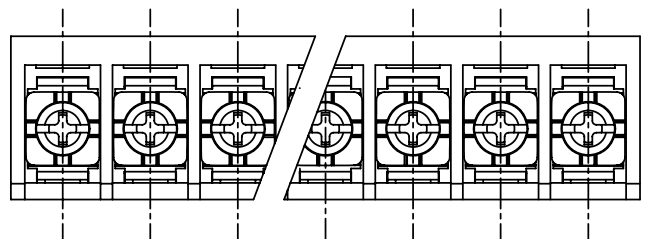

MATERIALS & ELECTRICAL
 RATED VOLTAGE & CURRENT: 300 V, 30 A
 WITHSTAND VOLTAGE: AC 2000 V/Min
 INSULATION RESISTANCE: 1000 MΩ OR MORE AT DC 500 V
 OPERATING TEMPERATURE RANG: -40 °C ~ +115 °C
 SCREW TORQUE VALUE: 9.5 Lb-In.
 WIRE RANGE: 22-10AWG str/sol
 1) HOUSING: Thermoplastic, UL 94 V-0 BLACK
 2) TERMINAL: BRASS, 0.8t
 3) TERMINAL SCREWS: STEEL, M4
 APPROVAL:

DIMENSION

Dim A	N×11.0±2.0
Dim B	(N-1)×11.0

N=Number of poles

Poles	Tolerance
2p-4p	±0.30
5p-8p	±0.40
9p-16p	±0.50
17p-23p	±0.60
24p-32p	±0.80

PART NO.: YK 552xx 0 x 0 JOG

No. of poles	Terminal	Screw
02 2 poles	G/F	G/F
03 3 poles	G/F	Zinc
...
32 32 poles	Tin	G/F
	Tin	Zinc

RoHS compliant
(lead<4%)
In copper Alloy

mat'l. code		surface ASME Y14.5	tolerance ASME Y14.5	projection 	product family TERMINAL BLOCK
ltr	ecn no	dr	date		title TERMINAL BLOCK
				tolerances unless otherwise specified	BARRIER TYPE
				angles 	scale MM
				X±0.5	dwg no YK552xx0x0JOG
				X.X±0.3	sheet 1 of 1 size A4
				X'±1"	X.XX±0.1
				dr	EVAN LU 061614
				enr	EVAN LU 061614
				chr	HANKE FENG 061614
				appd	SHI JUN 061614
sheet index		revision	A	type CUSTOMER Drawing	
		sheet	1		