

Printed-circuit board connector - DMC 1,5/12-G1F-3,5-LRP20THRR72 - 1706067

Please be informed that the data shown in this PDF Document is generated from our Online Catalog. Please find the complete data in the user's documentation. Our General Terms of Use for Downloads are valid (<http://phoenixcontact.com/download>)



Header, Nominal current: 8 A, Rated voltage (III/2): 160 V, Number of positions: 12, Pitch: 3.5 mm, Color: black, Contact surface: Tin, Mounting: THR soldering

The figure shows a 10-pos. version with 20 contacts

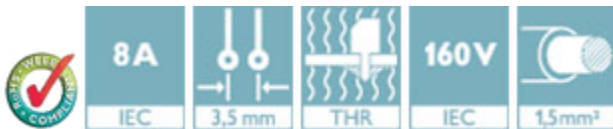

Key Commercial Data

Packing unit	1 pc
Minimum order quantity	180 pc
Custom tariff number	85366990
Country of origin	Germany

Technical data

Product type	PCB headers
Approval	VDE report with production monitoring
	IECEE CB Scheme
	cULus Recognized
	EAC
Rated voltage (IEC)	160
Rated current (IEC)	8
Mounting type	THR soldering
Number of positions	12
Pitch	3.5 mm
Levels	double-level
Type of locking	Lock & release threaded flange
Plug-in system	MINI COMBICON - DFMC 1,5

Printed-circuit board connector - DMC 1,5/12-G1F-3,5-LRP20THRR72 - 1706067

Technical data

Product family	DMC 1,5/...G1F-THR
Contact type	Male connector

Classifications

eCl@ss

eCl@ss 4.0	272607xx
eCl@ss 4.1	27260701
eCl@ss 5.0	27260701
eCl@ss 5.1	27260701
eCl@ss 6.0	27260704
eCl@ss 7.0	27440402
eCl@ss 8.0	27440402
eCl@ss 9.0	27440402

ETIM

ETIM 3.0	EC001121
ETIM 4.0	EC002637
ETIM 5.0	EC002637

UNSPSC

UNSPSC 6.01	30211810
UNSPSC 7.0901	39121409
UNSPSC 11	39121409
UNSPSC 12.01	39121409
UNSPSC 13.2	39121409

Approvals

Approvals

Approvals

VDE Gutachten mit Fertigungsüberwachung / IECCE CB Scheme / cULus Recognized / EAC

Ex Approvals

Printed-circuit board connector - DMC 1,5/12-G1F-3,5-LRP20THRR72 - 1706067

Approvals

Approvals submitted

Approval details

VDE Gutachten mit Fertigungsüberwachung 	
Nominal current IN	8 A
Nominal voltage UN	160 V

IECEE CB Scheme 	
Nominal current IN	8 A
Nominal voltage UN	160 V

cULus Recognized		
	B	C
Nominal current IN	8 A	8 A
Nominal voltage UN	150 V	50 V

EAC

Drawings

Printed-circuit board connector - DMC 1,5/12-G1F-3,5-LRP20THRR72 - 1706067

Schematic diagram

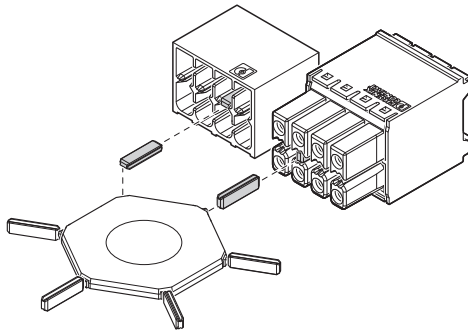

Drilling diagram

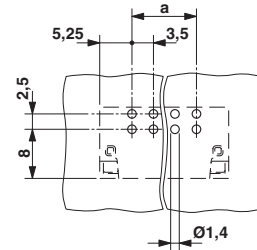

Use of the CP-DMC... coding profile

Diagram

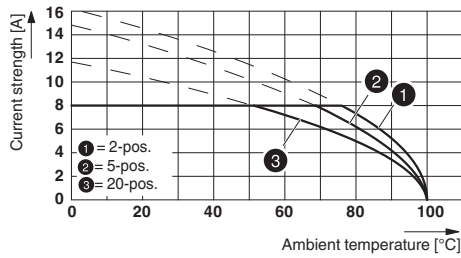

Dimensional drawing

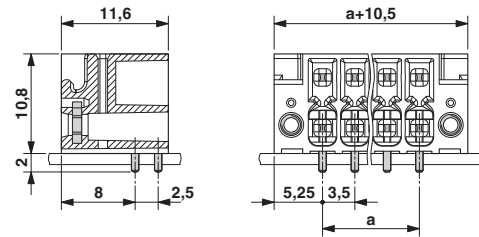

Schematic diagram

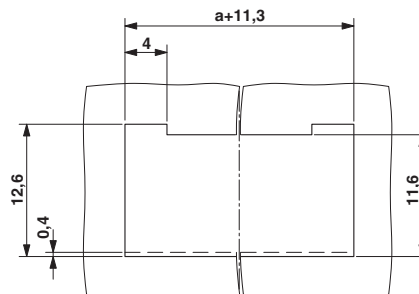

Panel cutout