

Tous droits strictement réservés. Reproduction ou communication à des tiers interdite sous quelque forme que ce soit sans autorisation écrite du propriétaire. Propriété de c FCI. Droits de reproduction FCI.



All rights strictly reserved. Reproduction or issue to third parties in any form whatever is not permitted without written authority from the proprietor. Property of FCI. Copyright FCI.

PRODUCT NO. 51940-177-- NOTE: ③	POWER			
	P4	P3	P2	P1
	PC	PC	PC	PC

1 | 2

3 |

4

DIM "M" ±.010
[±0.25]

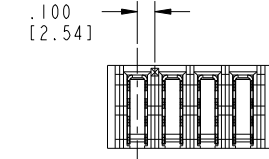
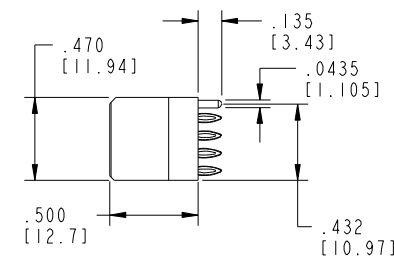
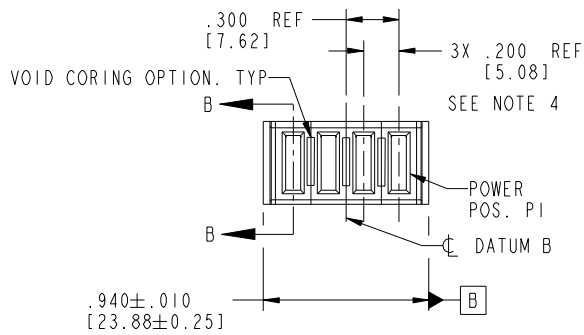
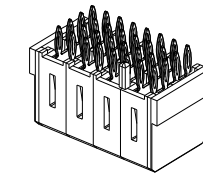
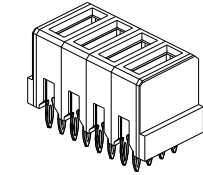
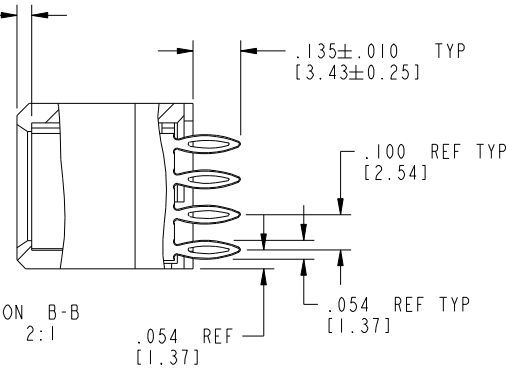

CODE	DIM "M" MATING LENGTH	CONTACT TYPE
PC	.042 [1.07]	POWER

mat'l code SEE NOTE 2				tolerances unless otherwise specified		CUSTOMER	
ltr	ecn no.	dr	date	linear	.XX±.01/0.X±0.3	COPY	
A	DG05-0486	GUOJM	11/22/05		.XXX±.005/0.XX±0.13	projection	
B	DG06-0202	GUOJM	05/30/06	angles	.XXX±.0020/0.XXX±0.051	INCH/MM	
C	DG06-0392	LJCN	09/19/06		0°±2°	scale	
				dr	JM Guo 11/22/05	1:1	
				enr	SLUO 11/22/05	A	
				chr	VICTOR LIN 11/22/05	51940-177	
				appd	JOSEPH HSIA 11/22/05	213	
sheet index	revision sheet	C	C	C		1 of 3	
		1	2	3			

www.fciconnect.com		title	
4P		VERTICAL PF RECEPT	
product family		code	
PwrBlade		213	
size		sheet	
dwg no		1 of 3	
51940-177			

1 | 2

3 |

4

Pro/E

cage code 22526

Tous droits strictement reserves. Reproduction ou communication a des tiers interdite sous quelque forme que ce soit sans autorisation écrite du propriétaire. Propriete de c FCI. Droits de reproduction FCI.



All rights strictly reserved. Reproduction or issue to third parties in any form whatever is not permitted without written authority from the proprietor. Property of FCI. Copyright FCI.

PRODUCT NUMBER
51940-177--
NOTE: ③

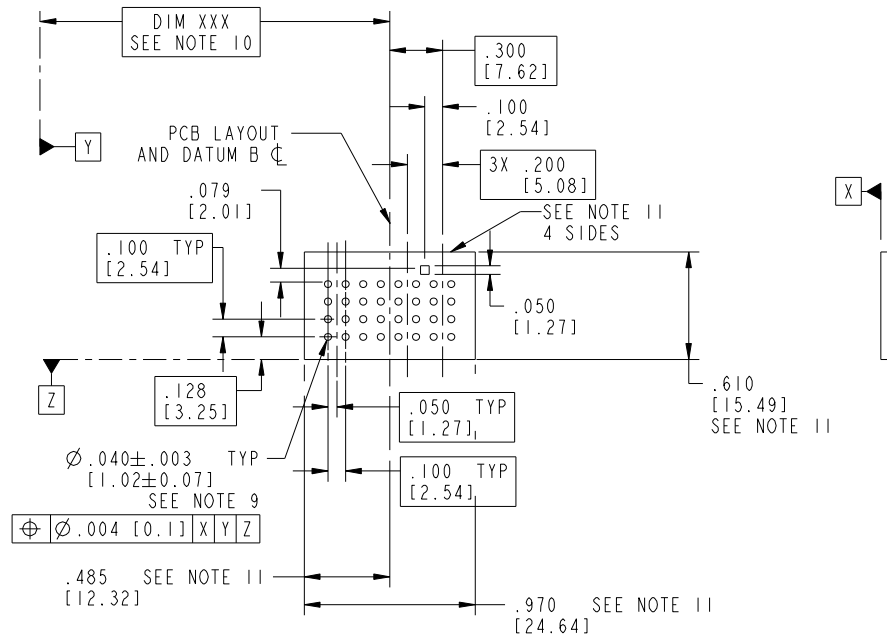

mat'l code		SEE NOTE 2		tolerances unless otherwise specified		CUSTOMER		FCI		www.fciconnect.com	
ltr	ecn no.	dr	date	linear	.XX±.01/0.X±0.3	COPY		title			
C					.XXX±.005/0.XXX±0.13	projection		4P			
				angles	.XXX±.0020/0.XXX±0.051			VERTICAL PF RECEPT			
				dr	JM Guo 11/22/05	INCH/MM		product family		PwrBlade	code
				enr	SLUO 11/22/05	scale		size		dwg no	213
				chr	VICTOR LIN 11/22/05	1:1		A		51940-177	sheet
				appd	JOSEPH HSIA 11/22/05						2 of 3
sheet index		revision sheet									

Pro/E

cage code 22526

Tous droits strictement reserves. Reproduction ou communication a des tiers interdite sous quelque forme que ce soit sans autorisation écrite du propriétaire. Propriete de c FCI. Droits de reproduction FCI.



All rights strictly reserved. Reproduction or issue to third parties in any form whatever is not permitted without written authority from the proprietor. Property of FCI. Copyright FCI.

PRODUCT NUMBER
51940-177__
NOTE: (3)

NOTES:

1. DIMENSIONS AND TOLERANCES ARE IN ACCORDANCE WITH ASME Y14.5M, 1994 UNLESS OTHERWISE SPECIFIED.

CONNECTOR NOTES:

(2) HOUSING MATERIAL: UL 94 V-0 GLASS FILLED HIGH-TEMP THERMOPLASTIC
POWER CONTACT MATERIAL: COPPER ALLOY
SIGNAL PIN MATERIAL: COPPER ALLOY

3. 51940-177;51940-177LF;51940-177GLF PLATING SPEC. SEE PRINT:10064183

(4) MANUFACTURER'S NAME, P/N, AND DATE CODE TO APPEAR ON THIS SURFACE.

5. PRODUCT SPECIFICATION GS-12-149.
APPLICATION SPECIFICATION BUS-20-067.

6. PACKAGED IN TRAYS.

PCB NOTES:

7. ALL HOLE DIAMETERS ARE FINISHED HOLE SIZE.

(8) MOUNTING HOLES, WHERE APPLICABLE, ARE UNPLATED.

(9) $\varnothing .0453 \pm .0010$ [1.151 \pm 0.025] DRILLED HOLES PLATED WITH .0003 [0.008] MIN SnPb OR Sn OVER .001 [0.03] TO .003 [0.08] Cu PLATING TO ACHIEVE $\varnothing .040 \pm .003$ [1.02 \pm .07] HOLE.

(10) "DIM XXX" TO BE DETERMINED BY THE CUSTOMER.

(11) CONNECTOR KEEP-OUT ZONE.

mat'l code		SEE NOTE 2		tolerances unless otherwise specified		CUSTOMER				www.fciconnect.com	
ltr	ecn no.	dr	date	linear	.XX±.01/0.X±0.3	COPY					
C					.XXX±.005/0.XX±0.13	projection			title 4P		
				angles	.XXX±.0020/0.XXX±0.051			product family PwrBlade		code 213	
				dr	0°±2°	INCH/MM		size	dwg no	sheet 3 of 3	
				enrg	JM Guo 11/22/05	scale 1:1		A 51940-177			
				chr	SLUO 11/22/05						
				appd	VICTOR LIN 11/22/05						
					JOSEPH HSIA 11/22/05						
sheet index	revision sheet										

cage code 22526

1 | 2

3 |

4

1 | 2

Pro/E

3 |

4