

LOC	DIST	REVISIONS			
P	LTN	DESCRIPTION	DATE	DMN	APVD
I		PRELIMINARY	19SEP2012	DZ	JY

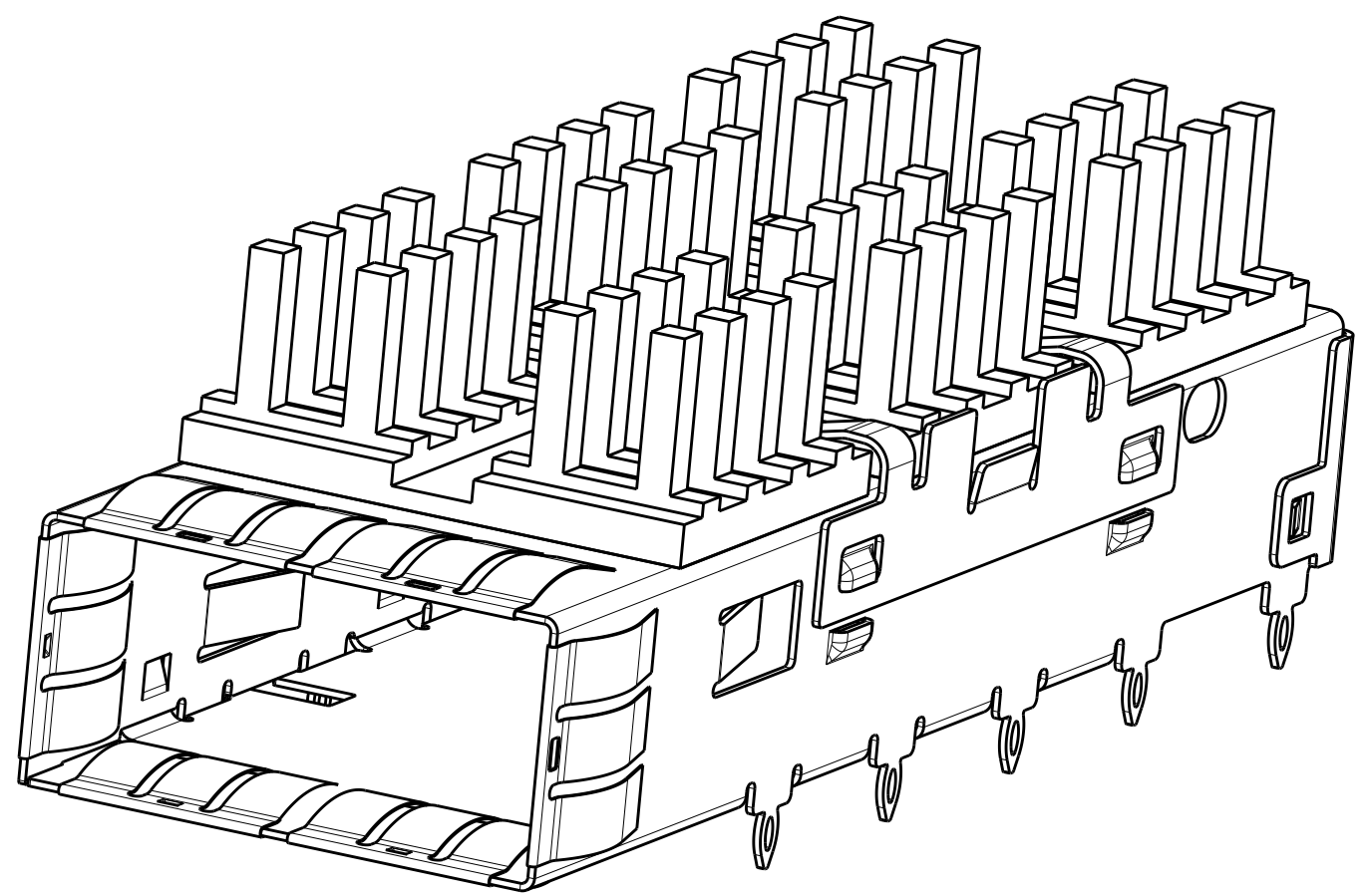

SCALE 4:1

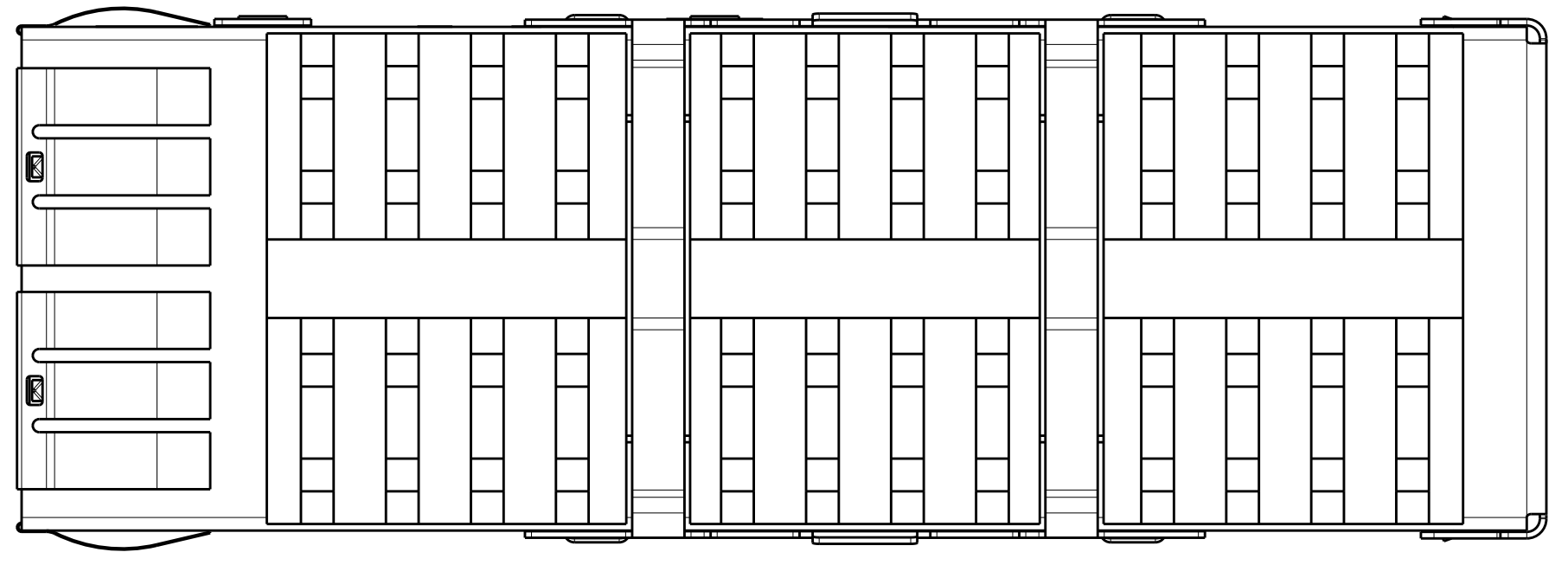

- 1. CAGE MATERIAL: NICKEL SILVER, 0.25 THICK  
 HEAT SINK MATERIAL: ALUMINUM  
 HEAT SINK CLIP MATERIAL: STAINLESS STEEL  
 EMI SPRINGS MATERIAL: COPPER ALLOY
- 2. MINIMUM PITCH DIMENSION.
- 3. MATES WITH QSFP MSA COMPATIBLE TRANSCEIVER.
- 4. REFERENCE APPLICATION SPEC 114-13217 FOR RECOMMENDED DRILL HOLE DIAMETER AND PLATING THICKNESS.
- 5. DATUMS AND BASIC DIMENSIONS ESTABLISHED BY CUSTOMER.
- 6. MINIMUM PC BOARD THICKNESS:  
 SINGLE SIDED = 1.45mm (shown, pg. 4)  
 DOUBLE SIDED = 2.2mm
- 7. HEATSINK AND CLIP SHIPPED ASSEMBLED TO CAGE ASSEMBLY. CAGE ASSEMBLY MAY BE PRESSED INTO THE PCB AS SHIPPED.
- 8. DATUM **-A-** IS TOP SURFACE OF HOST BOARD.
- 9. SURFACE TRACES PERMITTED WITHIN THIS AREA EXCEPT WHERE CAGE STANDOFFS, SHOWN IN DETAIL J, CONTACT PC BOARD.
- 10. DIMENSION APPLIES WITH MODULE INSTALLED IN THE CAGE.
- 11. DATE CODE MARKED ON TOP OF CAGE AND CONCEALED BY HEAT SINK APPLIES TO CAGE ASSEMBLY ONLY.
- 12. SPRING FINISH: 0.8um MIN TIN OVER 0.8um MIN NICKEL. NON-PLATED EDGES PERMISSIBLE.  
 HEAT SINK FINISH: 0.076 um MIN NICKEL.

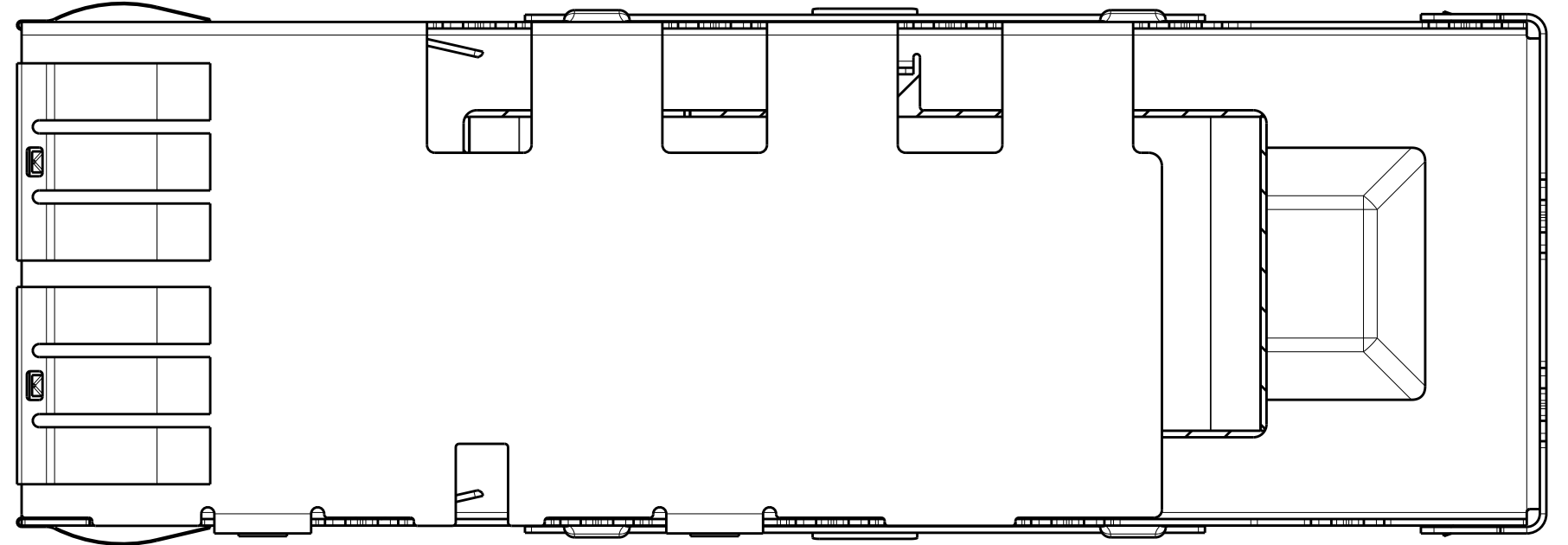
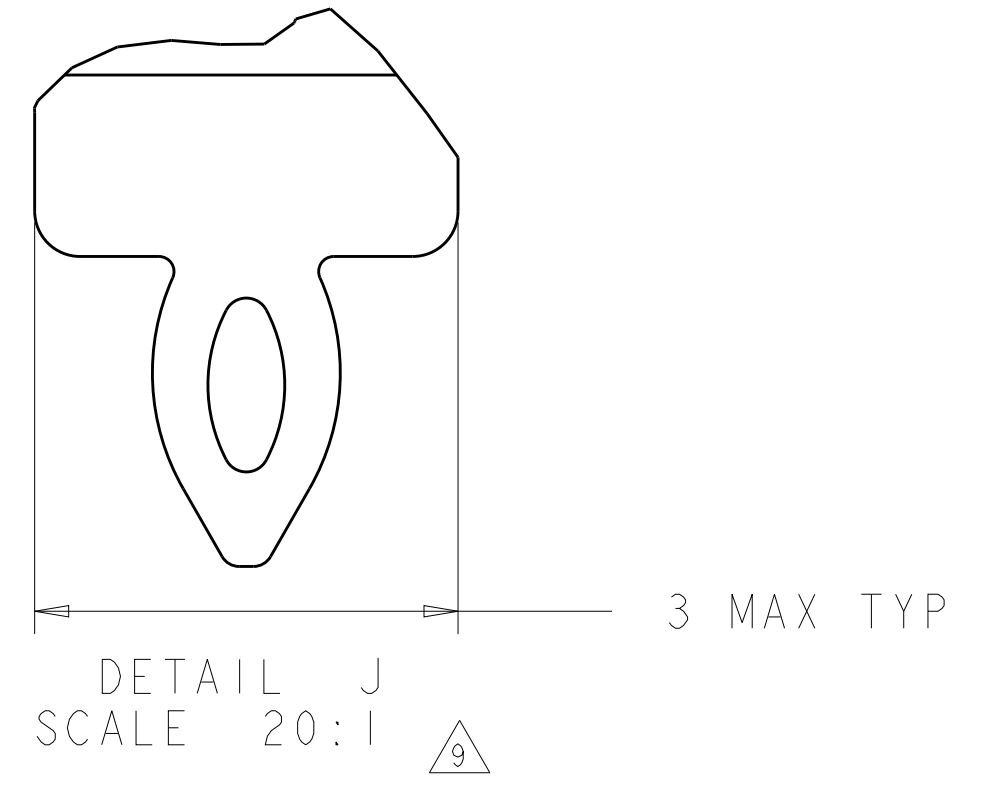
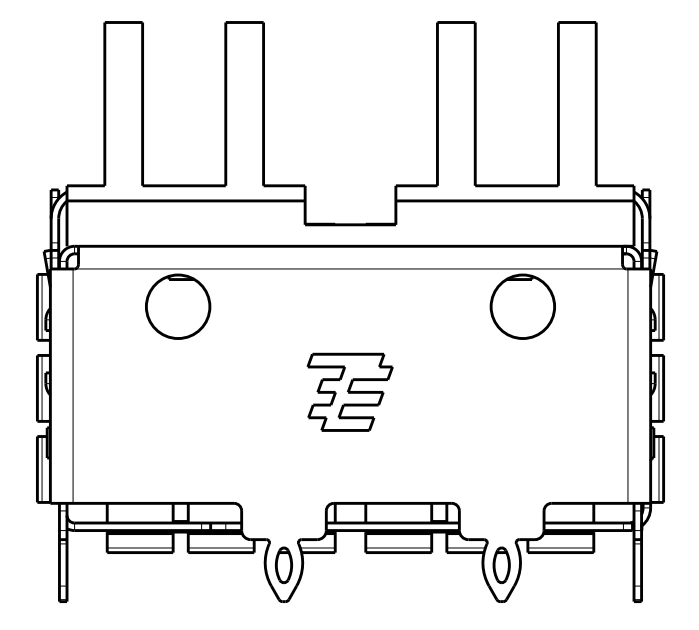
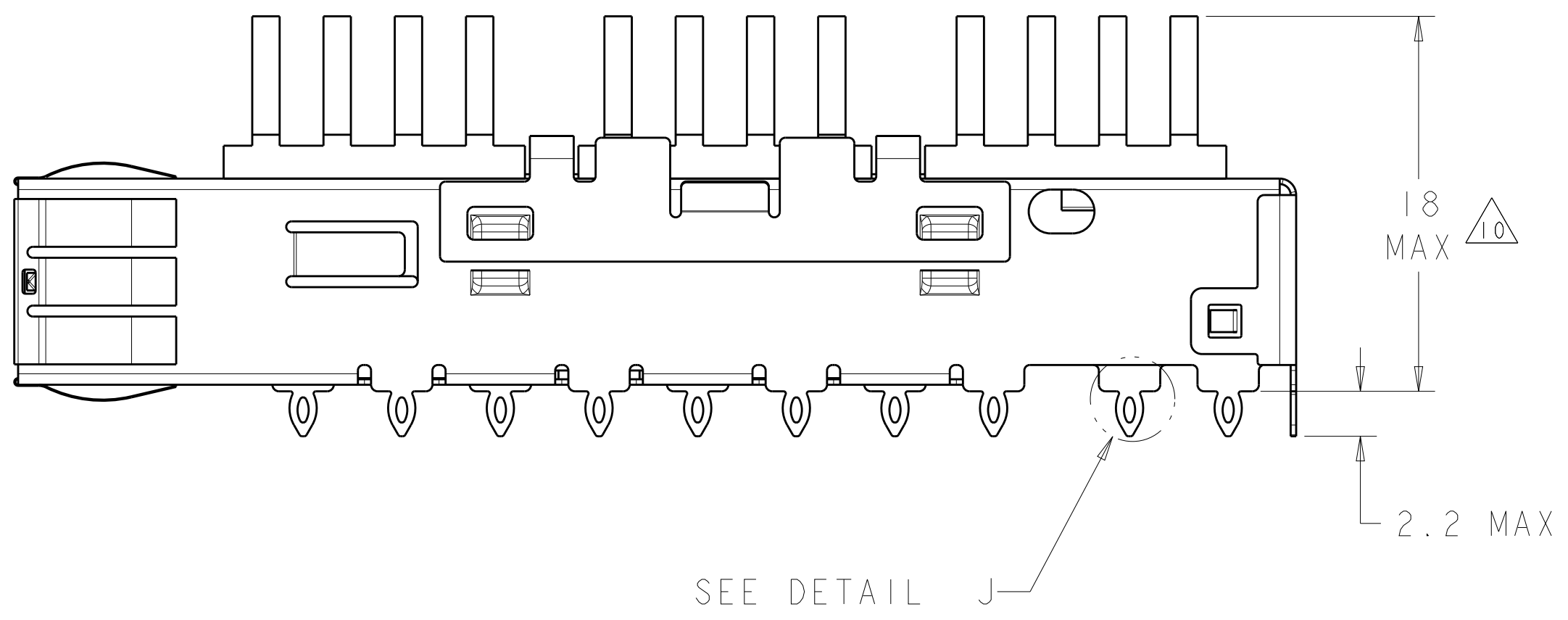
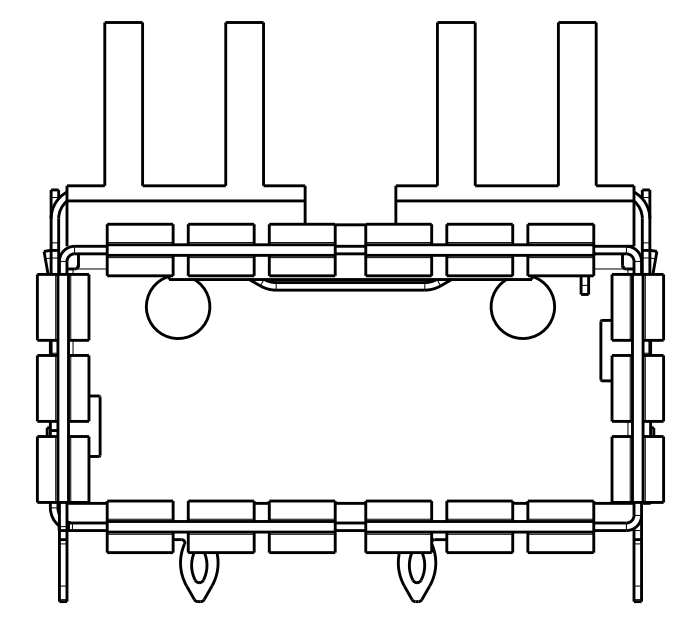

PART NUMBER  
2170450-1

THIS PRINT IS  
**PRELIMINARY**  
UNQUALIFIED PRODUCT  
CONTACT PRODUCT ENGINEERING  
BEFORE USING THIS PRINT

THIS DRAWING IS A CONTROLLED DOCUMENT.		DMN: D. ZHU 19SEP2012		TE Connectivity <b>PRELIMINARY</b>		
DIMENSIONS:		CHK: J. YANG 19SEP2012				
TOLERANCES UNLESS OTHERWISE SPECIFIED:		APVD: A. GAI 19SEP2012				
mm		NAME: CAGE ASSEMBLY, THRU BEZEL, QSFP WITH HEAT SINK				
0 PLC	±	PRODUCT SPEC	SIZE	CAGE CODE	DRAWING NO	RESTRICTED TO
1 PLC	±0.25	108-2286	A1	00779	C=2170450	-
2 PLC	±0.13	APPLICATION SPEC	SCALE	2:1	SHEET	1
3 PLC	±	114-13217	Customer Drawing	4	REV	1
4 PLC	±	WEIGHT				
ANGLES	±					
MATERIAL	±					
FINISH	±					

LOC	DIST	REVISIONS					
		P.	LTN	DESCRIPTION	DATE	DWN	APVD
GP	00	-	-	SEE SHEET 1	-	-	-

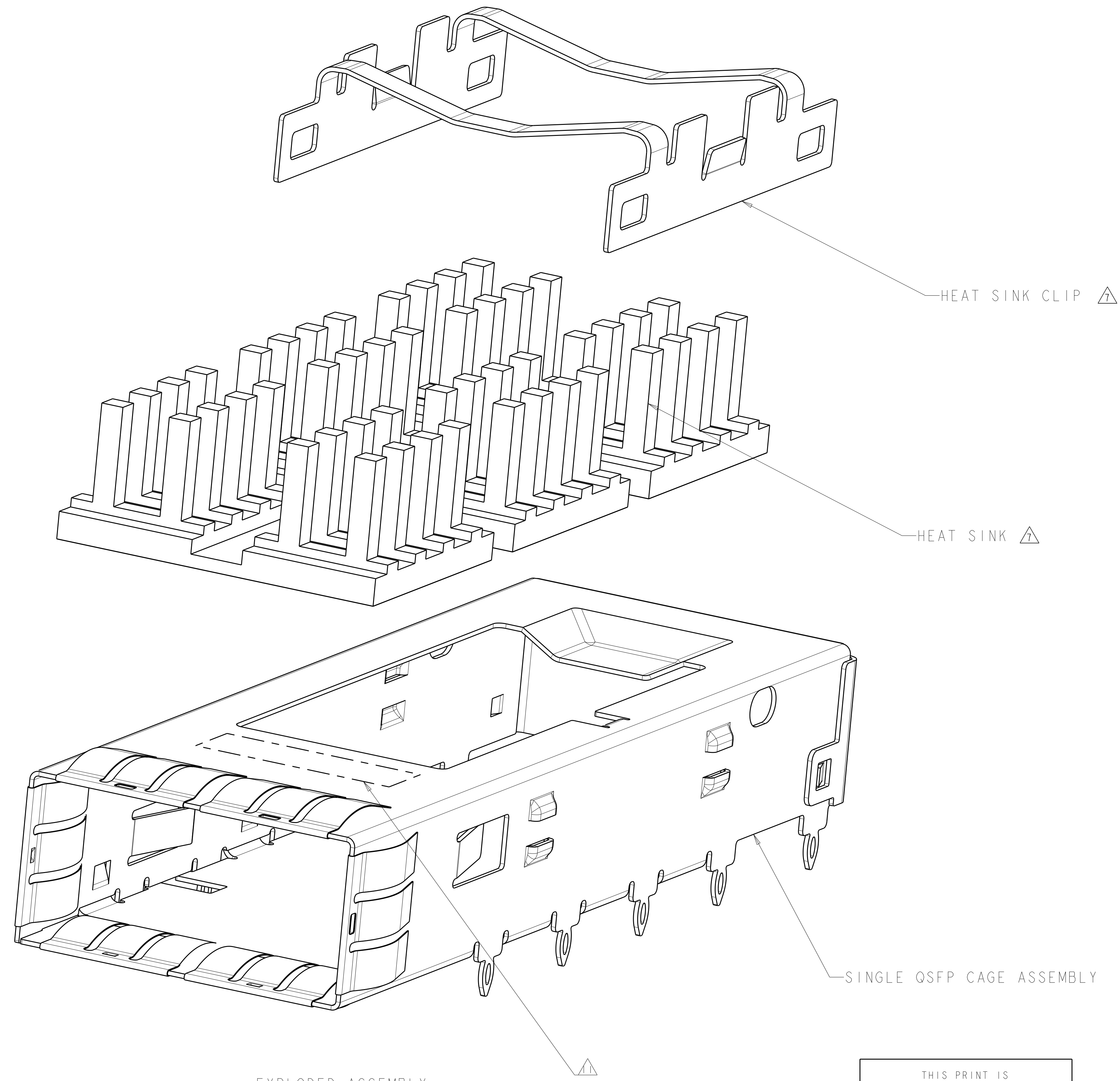

EXPLODED ASSEMBLY  
 SCALE 8:1

THIS PRINT IS  
**PRELIMINARY**  
 UNQUALIFIED PRODUCT  
 CONTACT PRODUCT ENGINEERING  
 BEFORE USING THIS PRINT

THIS DRAWING IS A CONTROLLED DOCUMENT.		DWN D. ZHU	19SEP2012	TE Connectivity NAME CAGE ASSEMBLY, THRU BEZEL , QSFP WITH HEAT SINK PRODUCT SPEC 108-2286 APPLICATION SPEC 114-13217 WEIGHT - Customer Drawing	RESTRICTED TO	
DIMENSIONS:		CHK J. YANG	19SEP2012		SIZE	
mm		APVD A. CAI	19SEP2012		CAGE CODE	DRAWING NO
0 PLC ± 1 PLC ±0.25 2 PLC ±0.13 3 PLC ± 4 PLC ± ANGLES ± FINISH ±					SCALE	2:1
MATERIAL				SHEET	2 OF 4	
				REV	1	

LOC	DIST	REVISIONS			
P	LTN	DESCRIPTION	DATE	DMN	APVD
GP	00	SEE SHEET 1	-	-	-

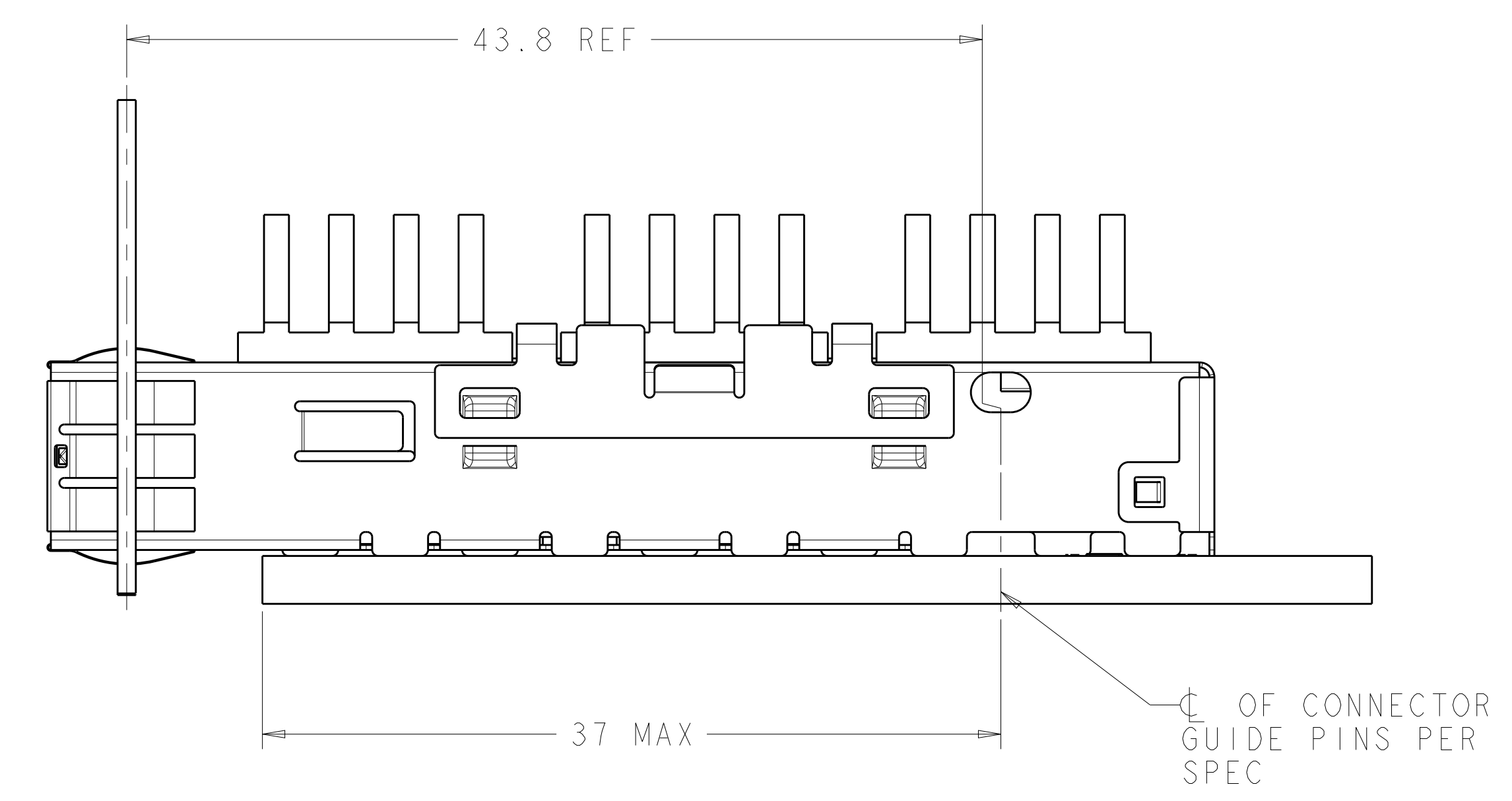
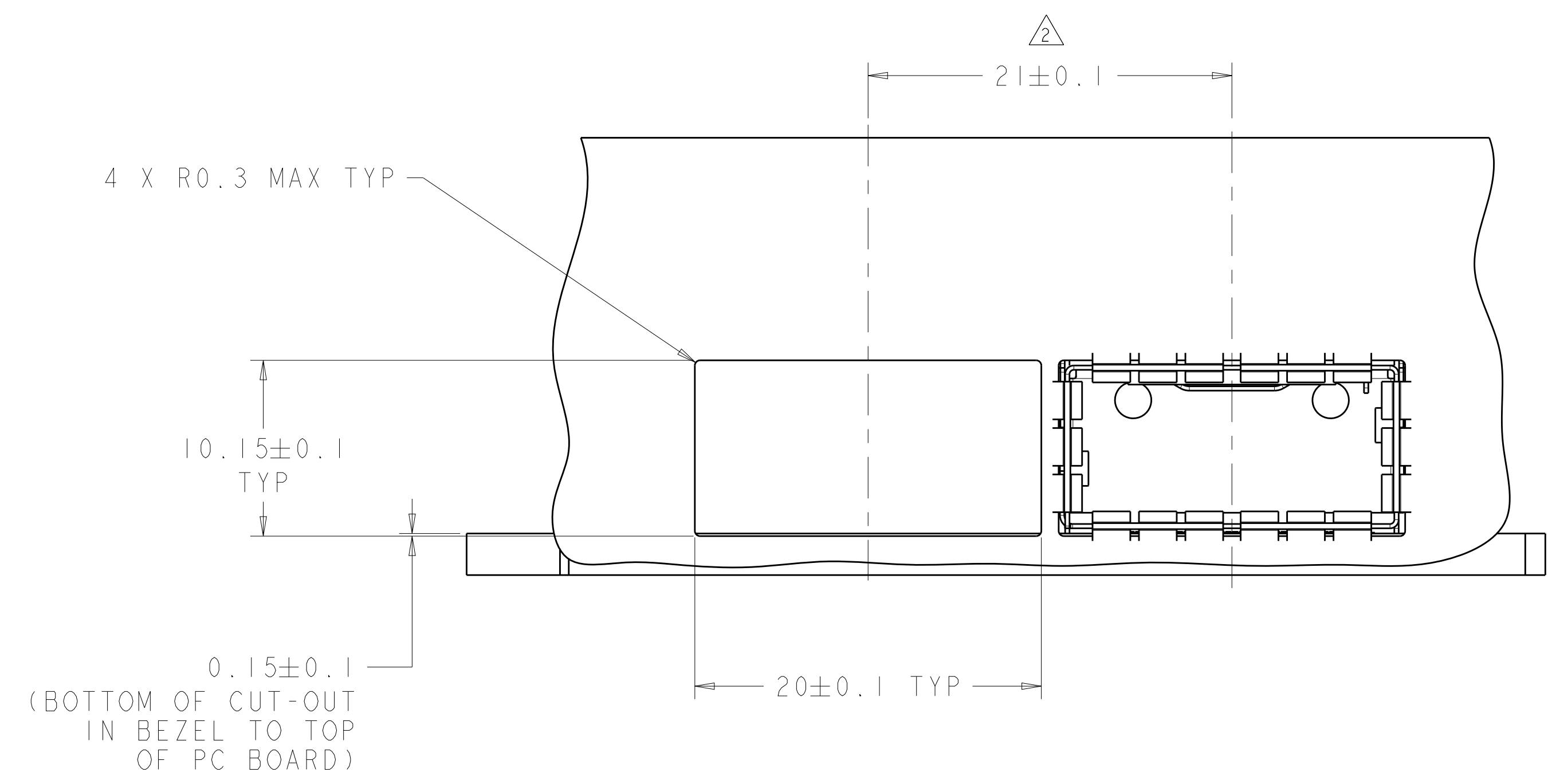

THIS PRINT IS  
**PRELIMINARY**  
 UNQUALIFIED PRODUCT  
 CONTACT PRODUCT ENGINEERING  
 BEFORE USING THIS PRINT

THIS DRAWING IS A CONTROLLED DOCUMENT.		DMN D. ZHU 19SEP2012	19SEP2012		NAME CAGE ASSEMBLY, THRU BEZEL, QSPF WITH HEAT SINK		
DIMENSIONS:		CHK J. YANG 19SEP2012	19SEP2012				
TOLERANCES UNLESS OTHERWISE SPECIFIED:		APVD A. CAI 19SEP2012	19SEP2012				
mm		PRODUCT SPEC	108-2286				
0 PLC	±	APPLICATION SPEC	114-13217	SIZE	CAGE CODE	DRAWING NO	RESTRICTED TO
1 PLC	±0.25	WEIGHT	-	A1	00779	C=2170450	-
2 PLC	±0.13	MATERIAL	-	Customer Drawing	SCALE	2:1	SHEET 3 OF 4
3 PLC	±	FINISH	-				REV 1
4 PLC	±						
ANGLES	±						

LOC	DIST	REV	DATE	BY	APPD
GP	00				

REVISIONS			
NO.	DESCRIPTION	DATE	BY
1	SEE SHEET 1		

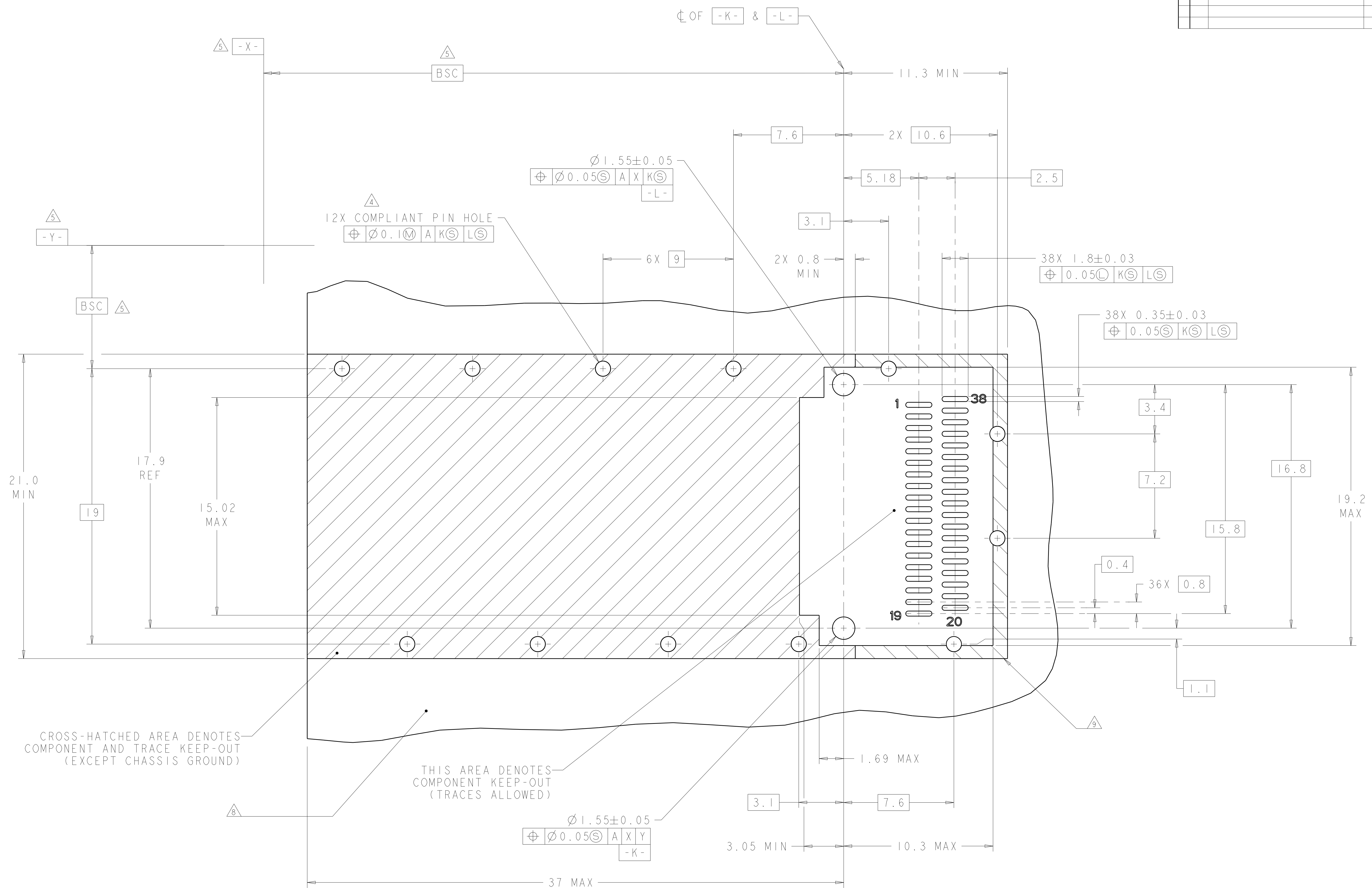

CROSS-HATCHED AREA DENOTES COMPONENT AND TRACE KEEP-OUT (EXCEPT CHASSIS GROUND)

THIS AREA DENOTES COMPONENT KEEP-OUT (TRACES ALLOWED)

RECOMMENDED PCB LAYOUT  
 SCALE 8:1

THIS PRINT IS  
**PRELIMINARY**  
 UNQUALIFIED PRODUCT  
 CONTACT PRODUCT ENGINEERING  
 BEFORE USING THIS PRINT

THIS DRAWING IS A CONTROLLED DOCUMENT.		OWN: D. ZHU 19SEP2012	TE Connectivity NAME: CAGE ASSEMBLY, THRU BEZEL, QSPF WITH HEAT SINK PRODUCT SPEC: 108-2286 APPLICATION SPEC: 114-13217 WEIGHT: A100779C=2170450 Customer Drawing
DIMENSIONS: mm		CHK: J. YANG 19SEP2012	
TOLERANCES UNLESS OTHERWISE SPECIFIED:		APVD: A. CAI 19SEP2012	
0 PLC ± 1 PLC ±0.25 2 PLC ±0.13 3 PLC ± 4 PLC ± ANGLES ±		SIZE: CAGE CODE DRAWING NO: 100779C=2170450	
MATERIAL: FINISH:		RESTRICTED TO:	SCALE: 2:1 SHEET 4 OF 4 REV 1