

THIS DRAWING IS UNPUBLISHED. RELEASED FOR PUBLICATION 2003
 © COPYRIGHT 2003 BY TYCO ELECTRONICS CORPORATION. ALL RIGHTS RESERVED.

| LOC | DIST | REVISIONS | | | | | |
|-----|------|-----------|-----|-------------------------|-----------|-----|------|
| | | P | LTR | DESCRIPTION | DATE | DWN | APVD |
| A1 | - | B2 | | NEW CAD-DRAWING CREATED | 08MAY2003 | - | - |

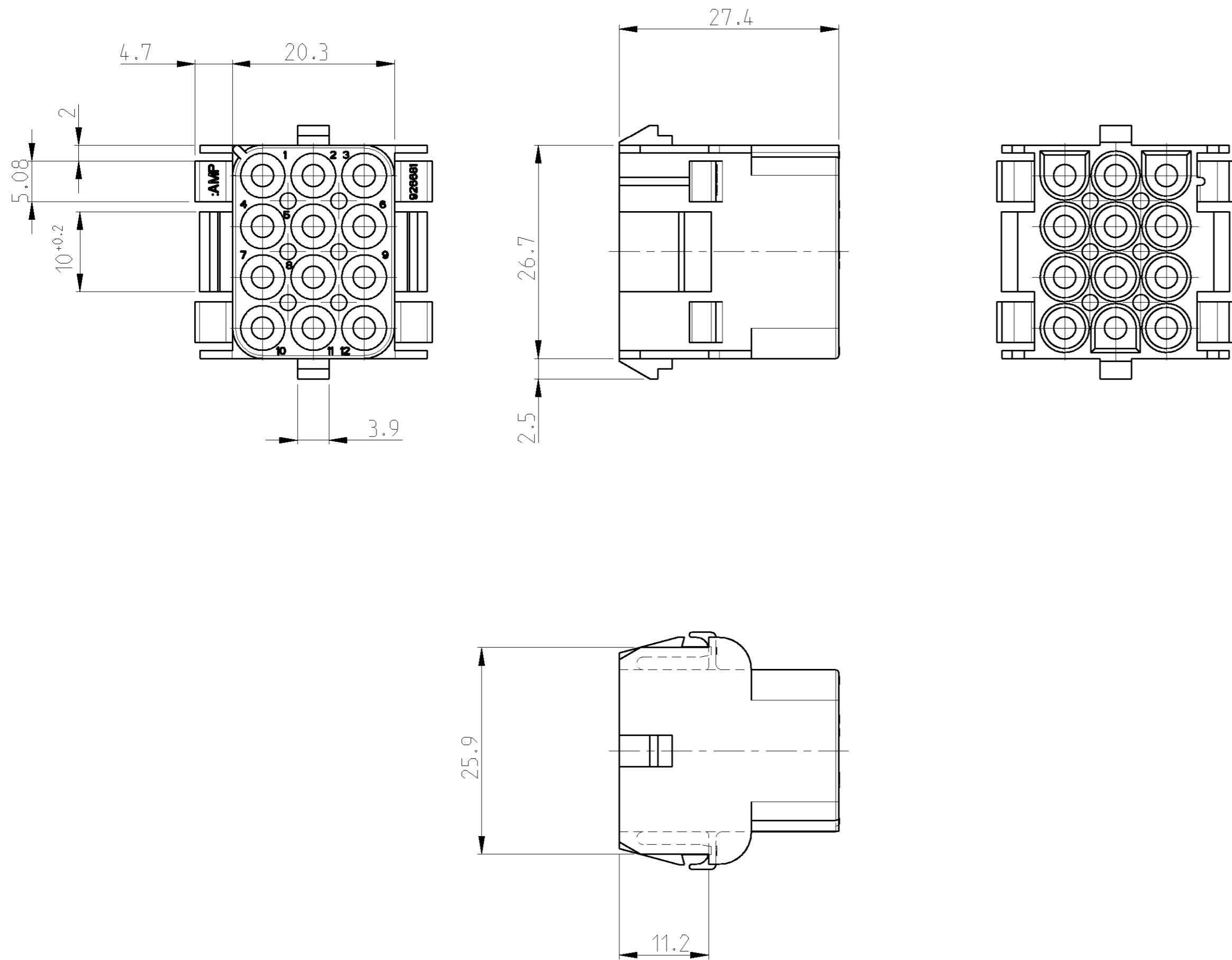

Montageausschnitt/PANEL CUT OUT
 Bestückungsseite/LOADING SIDE

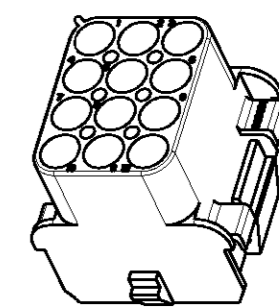
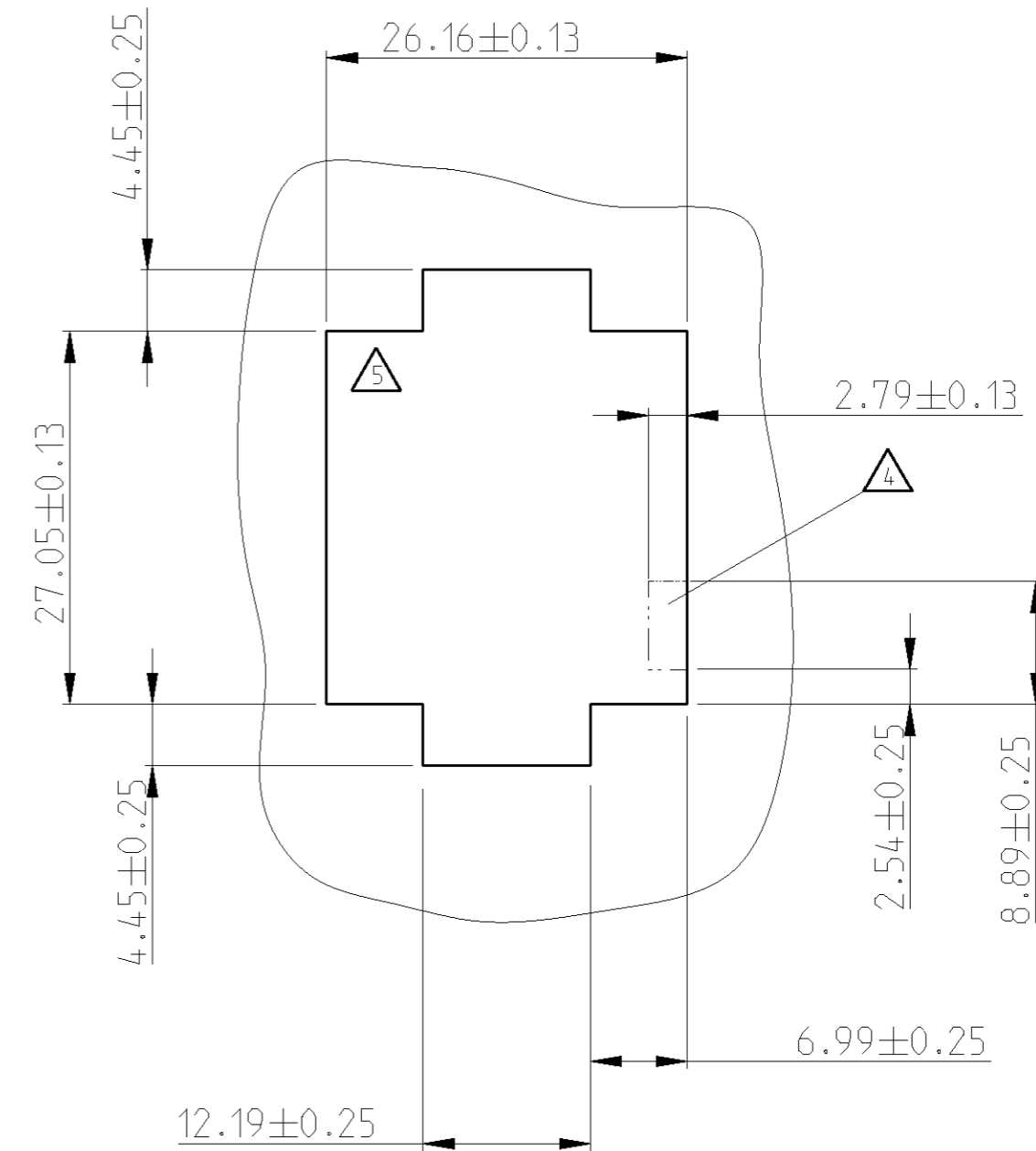

1:1

Bemerkungen
 NOTES

- Geeignet für UMNL Stift- und Buchsenkontakte
 BEEN SUITABLE FOR UMNL PIN- AND SOCKET CONTACTS
- Empfohlene Blechstärke 0.75 - 2.3 mm
 RECOMMEND SHEET METAL THICKNESS 0.75 - 2.3 mm
- Gehäuse muß in Stanzrichtung eingeführt werden
 HOUSING MUST BE INTRODUCED TO PUNCHING DIRECTION
- △ Für verschlüsseltes Einsetzen der Gehäuse
 FOR CODED USING OF THE HOUSINGS
- △ Position von Kammer 1 bei verschlüsseltem Einsetzen
 POSITION OF CAVITY 1 FOR CODED USING
- △ Neues Material (Phosphor und Halogen frei)
 NEW MATERIAL (PHOSPHORUS AND HALOGENOUS FREE)

| | | | |
|----------|------|-------------------------------|-----------------|
| 926681-5 | B | PA6.6 UL94 V-2 | natur/NATURAL |
| 926681-4 | B | PA6.6 UL94 V-2 DURETHAN VPKU2 | weiß/WHITE |
| 926681-3 | B | PA6.6 UL94 V-0 | △ natur/NATURAL |
| 926681-2 | A | PA6.6 UL94 V-0 | △ schwarz/BLACK |
| 926681-1 | A | PA6.6 UL94 V-2 ZYTEL E101 | natur/NATURAL |
| PART NO. | REV. | MATERIAL | COLOR |

| | | | | |
|--|--|-------------------------------|---|-----------------------|
| THIS DRAWING IS A CONTROLLED DOCUMENT FOR TYCO ELECTRONICS CORPORATION IT IS SUBJECT TO CHANGE AND THE CONTROLLING ENGINEERING ORGANIZATION SHOULD BE CONTACTED FOR THE LATEST REVISION. | | DWN Abraham.G. 08MAY03 | tyco Electronics AMP GmbH tyco Electronics D - 64625 Bensheim | |
| DIMENSIONS: mm | | CHK Kampmann.H. 09MAY03 | NAME 12-pol. UMNL Aufnahmegehäuse UMNL 12-WAY CAP HSG | |
| TOLERANCES UNLESS OTHERWISE SPECIFIED: 0 PLC ± 1 PLC ± 0.2 2 PLC ± 3 PLC ± 4 PLC ± ANGLES ± FINISH | | APVD - | PRODUCT SPEC 108-1031 | |
| MATERIAL | | APPLICATION SPEC 114-18011 | SIZE A2 | RESTRICTED TO - |
| - | | WEIGHT 9.5 g | CAGE CODE 00779 | DRAWING NO. 926681 |
| - | | CUSTOMER DRAWING | SCALE 2:1 | SHEET 1 OF 1 |
| | | | | REV. B2 |