

104HC3102K4TM6

Conduction Cooled (High Density Resonant)

Parts are RoHS compliant

Parts are RoHS compliant

ELECTRICAL SPECIFICATIONS

Capacitance: 0.1 μ F

AC Current: 350 A

ESR: 1.2 milliOhms at 100 kHz and 20°C

Self Inductance: 5 Nanohenries maximum

Tolerance: -10 %, +10 %

Temperature Range: -40°C to +85°C

Maximum Core Temperature: 85°C

Resonant Frequency: 476-649 kHz

Maximum power (KVAR): 300

VAC: 1000 Volts AC

PHYSICAL DIMENSIONS

Length (L): 60 mm, 0.5 mm

Height (H): 60 mm, +/-0.5 mm

Thickness (B): 30.2 mm, +/-0.1 mm

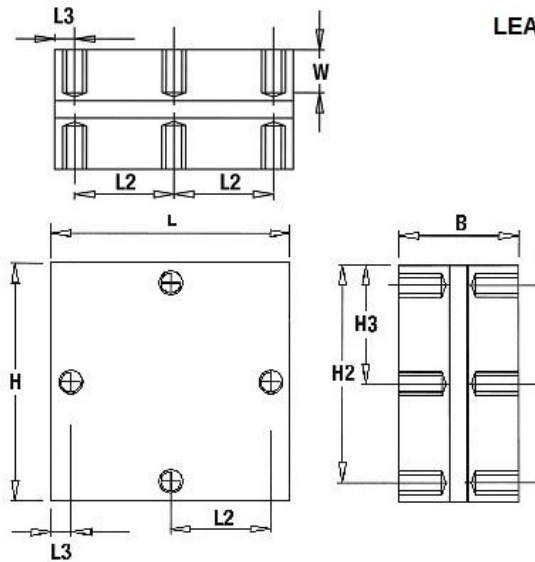

LEAD STYLE: 4TM6

L	H	B	H2	H3	L2	L3	W
60+0.5	60+0.5	30.2+0.1	55	30	25	55	10+0.5
Mounting holes: M6x1 tap filled with SS helicoil							
Tightening torque: 15Nm MAX							



3757 W. Touhy Ave. Lincolnwood, IL 60712 (847) 675-1760 FAX (847) 673-2850
Illinois Capacitor (HK) Ltd., Tel: 85227930931, Fax: 85227930731, www.illcap.com.hk
© Copyright 2017 Illinois Capacitor. A division of Cornell Dublier, All Rights Reserved